

TACOMA PUBLIC WORKS
VERTICAL DATUMS

FIXED DATUM

TIDAL DATUM

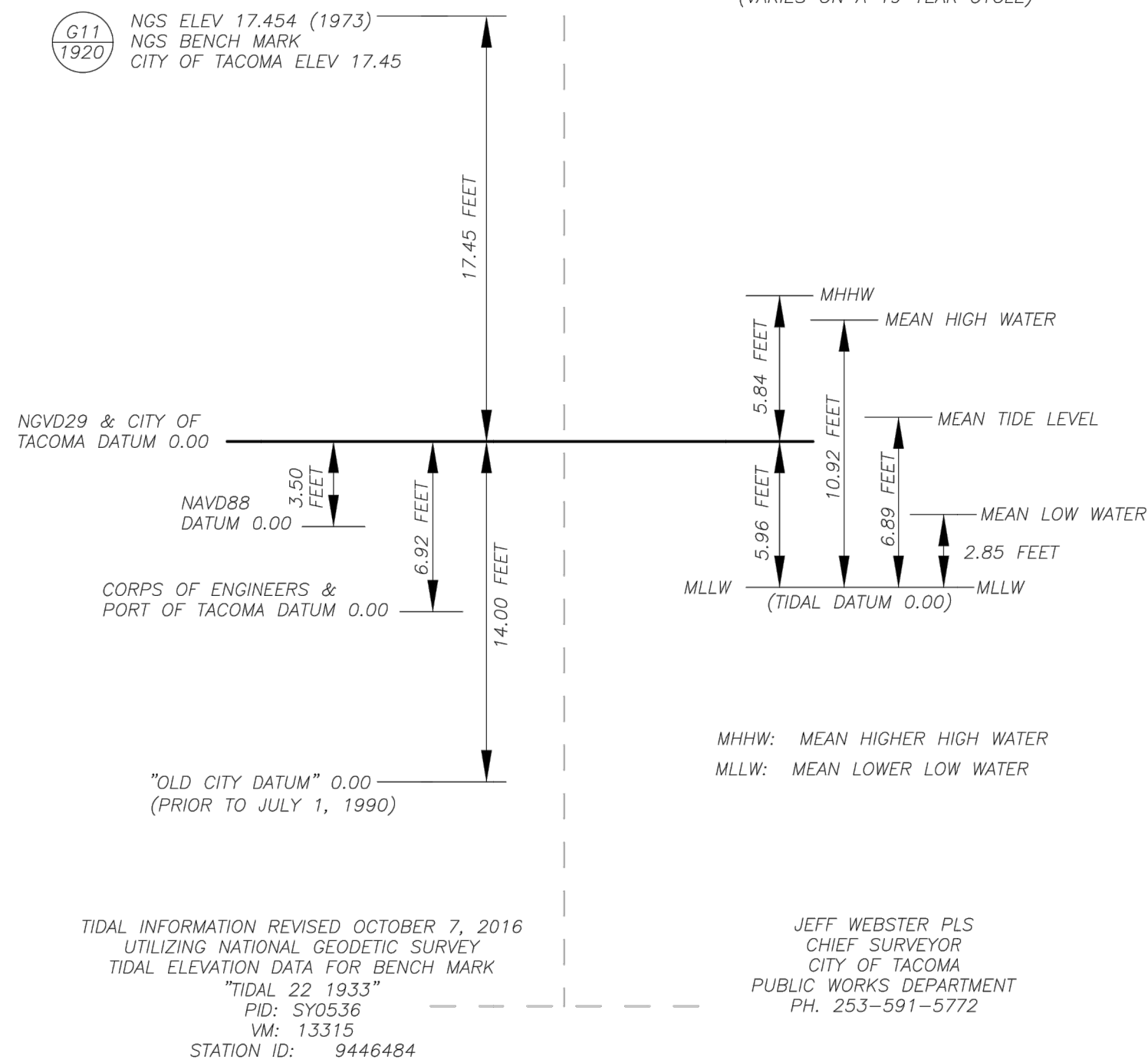

PORT OF TACOMA WAPATO CREEK BRIDGE AT PARCEL 15
DRIVEWAY AND CHANNELIZATION IMPROVEMENTS

ALEXANDER AVENUE
TACOMA, WASHINGTON

ABBREVIATIONS

BC	BOTTOM OF CURB
BW	BACK OF WALK
C&G	CURB & GUTTER
CL	CATCH BASIN
CL	CENTERLINE
CO	CLEANOUT
CONC	CONCRETE
CONST	CONSTRUCTION
DIA, Ø	DIAMETER
DIP	DUCTILE IRON PIPE
D/W	DRIVEWAY
E	EAST, EASTING
EX/EXIST	EXISTING
FF	FINISH FLOOR
FL	FLOW LINE
HP	HIGH POINT
IE	INVERT ELEVATION
LF	LINEAR FOOT
LT	LEFT
LP	LOW POINT
MECH	MECHANICAL
MH	MANHOLE
N	NORTH, NORTHING
NTS	NOT TO SCALE
P	POWER
PC	POINT OF CURVATURE
PCC	POINT OF COMBINED CURVATURE
P, P/L	PROPERTY LINE
PRC	POINT OF REVERSED CURVATURE
PT	POINT OF TANGENCY
PVC	POLYVINYL CHLORIDE/POINT OF VERTICAL CURB
R	RADIUS
RT	RIGHT
RTO	RETURN TO OWNER
R/W	RIGHT-OF-WAY
S	SOUTH
SD	STORM DRAIN
SS	SANITARY SEWER
STA	STATION
S/W	SIDEWALK
T	TELEPHONE
TC	TOP OF CURB
TYP	TYPICAL
U	UNDERGROUND
W	WEST
W/W	WATER/WEST
Ø	WITH
AT	AT

GENERAL PLAN NOTES

- COORDINATE ALL WORK WITH ON-SITE DOCUMENTS. FOR ON-SITE WORK, REFER TO THE BUILDING AND SITE DEVELOPMENT PERMITS.
- THE CONTRACTOR SHALL BE RESPONSIBLE FOR PROVIDING ADEQUATE SAFEGUARDS, SAFETY DEVICES, PROTECTIVE EQUIPMENT, FLAGGERS AND ANY OTHER NEEDED ACTIONS TO PROTECT THE LIFE, HEALTH AND SAFETY OF THE PUBLIC. ANY WORK WITHIN THE TRAVELED RIGHT-OF-WAY THAT MAY INTERRUPT NORMAL TRAFFIC FLOW SHALL REQUIRE NOTIFICATION AND COORDINATION WITH THE CITY OF TACOMA.
- ALL MATERIALS AND CONSTRUCTION SHALL BE IN ACCORDANCE WITH THE 2018 WASHINGTON STATE DEPARTMENT OF TRANSPORTATION (WSDOT) STANDARD SPECIFICATIONS FOR ROAD, BRIDGE, AND MUNICIPAL CONSTRUCTION AS MODIFIED FOR USE BY THE CITY OF TACOMA AND THE CITY OF TACOMA STANDARD PLANS.
- A COPY OF THE APPROVED PLANS AND SPECIFICATIONS SHALL BE ON-SITE WHENEVER CONSTRUCTION IS IN PROGRESS.
- PRIOR TO CONSTRUCTION, THE CONTRACTOR SHALL OBTAIN ALL PERMITS REQUIRED FOR WORK WITHIN THE PUBLIC RIGHT-OF-WAY.
- ALL LOCATIONS OF EXISTING UTILITIES SHOWN HEREON HAVE BEEN ESTABLISHED BY FIELD SURVEY OR OBTAINED FROM AVAILABLE RECORDS AND SHOULD THEREFORE BE CONSIDERED APPROXIMATE. ONLY AND NOT NECESSARILY COMPLETE. IT IS THE SOLE RESPONSIBILITY OF THE CONTRACTOR TO INDEPENDENTLY VERIFY THE ACCURACY OF ALL UTILITY LOCATIONS SHOWN AND TO FURTHER DISCOVER AND AVOID ANY OTHER UTILITIES NOT SHOWN HEREON WHICH MAY BE AFFECTED BY THE IMPLEMENTATION OF THIS PLAN.
- THE CONTRACTOR SHALL VERIFY THE LOCATIONS OF UTILITIES BY CONTACTING A UTILITY LOCATE SERVICE AND SHALL PROVIDE SUFFICIENT NOTIFICATION TO THE AFFECTED UTILITY COMPANIES PRIOR TO STARTING WORK. COORDINATE WORK FOR EXISTING UTILITIES WITH CONTACTS SHOWN IN THE UTILITY CONTACTS TABLE. CONTACT UNDERGROUND UTILITIES LOCATION AT 1-800-424-5555 AT LEAST 48 HOURS BEFORE COMMENCEMENT OF CONSTRUCTION.
- THE PROJECT HAS WORK OVER AN EXISTING 36" STEEL WATER MAIN OWNED BY TACOMA WATER. PLEASE PROVIDE 72 HOURS ADVANCE NOTICE PRIOR TO BEGINNING WORK CONTACT JIM GOODMAN AT TACOMA WATER SUPPLY (253)-502-8667.
- THE CONTRACTOR SHALL NOTIFY THE TACOMA FIRE DEPARTMENT (253) 591-5737 24 HOURS IN ADVANCE OF ALL WATER SERVICE INTERRUPTIONS, HYDRANT SHUTOFFS, AND STREET CLOSURES OR OTHER ACCESS BLOCKAGE. THE CONTRACTOR SHALL ALSO NOTIFY THE FIRE DEPARTMENT OF ALL NEW, RELOCATED, OR ELIMINATED HYDRANTS RESULTING FROM THIS WORK.
- THE CONTRACTOR SHALL MAINTAIN EMERGENCY VEHICLE ACCESS ON ALL AFFECTED STREETS AT ALL TIMES.
- MAINTAIN AND PROTECT ALL MANHOLES, CATCH BASINS, FIRE HYDRANTS, MONITORING WELLS, WATER VALVES, PIPING, SURVEY MONUMENTS, TRAFFIC CONTROL BOXES, WATER METERS AND ENGINEER OTHER IMPROVEMENTS UNLESS OTHERWISE NOTED ON THE PLANS. CONTRACTOR SHALL REPAIR OR REPLACE ALL ITEMS DAMAGED BY THE CONSTRUCTION OPERATIONS AT NO ADDITIONAL COST TO THE OWNER.
- THESE PLANS ARE APPROVED FOR CONSTRUCTION FOR A PERIOD OF 24 MONTHS FROM THE DATE OF CITY APPROVAL. THE CITY RESERVES THE RIGHT TO REQUIRE REVISIONS, ADDITIONS, DELETIONS, OR MODIFICATIONS SHOULD CONSTRUCTION BE DELAYED BEYOND THIS TIME LIMITATION OR IF FIELD CONDITIONS ARE DIFFERENT FROM WHAT IS DEPICTED ON THESE PLANS.
- THE CONTRACTOR IS RESPONSIBLE FOR PROVIDING A TRAFFIC CONTROL PLAN TO THE CITY THAT MEETS THE CRITERIA OF THE CITY OF TACOMA TRAFFIC CONTROL HANDBOOK AND RIGHT-OF-WAY DESIGN MANUAL. CONTACT PUBLIC WORKS TRAFFIC ENGINEER, PHONE # (253) 591-5554 FOR SPECIFIC TRAFFIC CONTROL REQUIREMENTS FOR THIS PROJECT. A TRAFFIC CONTROL PLAN SHALL BE SUBMITTED AND APPROVED PRIOR TO COMMENCING WORK.
- CONTRACTOR SHALL VERIFY ALL UTILITY POINTS OF CONNECTIONS TO EXISTING UTILITIES PRIOR TO CONSTRUCTION AND NOTIFY ENGINEER OF ANY DISCREPANCY.
- EXCAVATED MATERIAL MEETING PROJECT SPECIFICATIONS MAY BE USED FOR BACKFILL. NO STOCKPILING OF EXCAVATED MATERIAL IS ALLOWED WITHIN THE RIGHT-OF-WAY.
- THE CONSTRUCTION BASELINE ON THE PLANS IS LOCATED ON THE BRASS DISKS FOUND WITHIN THE CENTER OF ALEXANDER AVENUE; ALL DIMENSIONS, STATIONS AND OFFSETS ARE BASED ON THE CONSTRUCTION BASELINE UNLESS NOTED OTHERWISE.
- LIMITS OF PAVEMENT REMOVAL ARE SHOWN ON THE PLAN FOR BID PURPOSES. EXACT SAWCUT AND PAVEMENT REMOVAL LIMITS WILL BE DETERMINED BY THE CITY OF TACOMA CONSTRUCTION INSPECTOR IN THE FIELD.
- RESTORATION SHALL BE IN ACCORDANCE WITH THE CITY OF TACOMA ROW RESTORATION POLICY.
- THE ENGINEER OF RECORD SHALL PROVIDE AN ENGINEER'S CERTIFICATION TO THE CITY OF TACOMA AFTER FACILITY INSTALLATION AND PRIOR TO PERMIT FINAL INSPECTION AND/OR CLOSEOUT. THE ENGINEER'S CERTIFICATION SHALL INCLUDE:
 - THE PERMIT NUMBER
 - STATEMENTS TO ATTEST:
 - THAT ALL STORMWATER FACILITIES HAVE BEEN INSTALLED ACCORDING TO THE APPROVED PERMIT DOCUMENTS. CHANGES TO THE APPROVED PERMIT SET THAT ARE REQUIRED DURING CONSTRUCTION SHALL BE SUBMITTED TO BLUS FOR ESSE TO REVIEW AND APPROVAL DURING THE CONSTRUCTION PHASE AND PRIOR TO THE CHANGE BEING CONSTRUCTED.
 - AS-BUILT DRAWINGS HAVE BEEN PROVIDED TO THE CITY ELECTRONICALLY. THESE SHALL BE PROFESSIONALLY DRAFTED ENGINEERING DRAWINGS THAT ARE STAMPED, SIGNED, AND DATED BY A WASHINGTON STATE LICENSED ENGINEER. THE DRAWINGS MUST ACCURATELY REPRESENT THE PROJECT AS CONSTRUCTED.
 - THE OPERATIONS AND MAINTENANCE MANUAL IS LOCATED ONSITE.

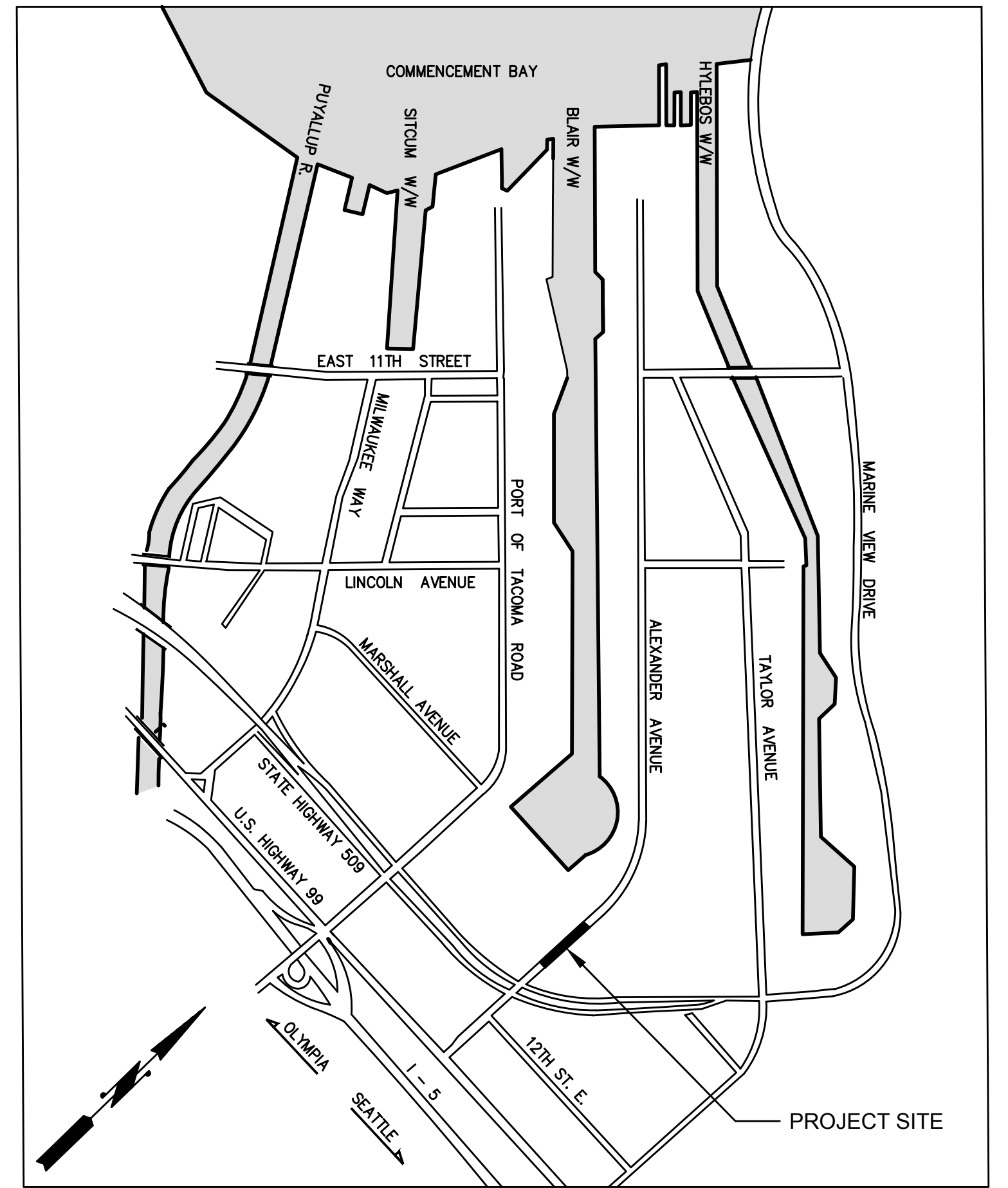

VICINITY MAP
NTS

TRAFFIC CONTROL NOTES

- LOCATION: ALEXANDER AVENUE
THE FOLLOWING SPECIAL TRAFFIC CONTROLS SHALL SUPPLEMENT SECTION 1-07.23 OF THE STANDARD SPECIFICATIONS.
- BIDIRECTIONAL TRAFFIC TO BE MAINTAINED ON ALEXANDER AVENUE THROUGHOUT THE DURATION OF PROJECT. THE CONTRACTOR IS RESPONSIBLE FOR PROVIDING A TRAFFIC CONTROL PLAN TO THE CITY THAT MEETS THE CITY OF TACOMA TRAFFIC CONTROL HANDBOOK AND RIGHT-OF-WAY DESIGN MANUAL. CONTACT TRAFFIC DEPARTMENT, PHONE NUMBER (253) 591-5554, FOR SPECIFIC TRAFFIC CONTROL REQUIREMENTS FOR THIS PROJECT. A TRAFFIC CONTROL PLAN SHALL BE SUBMITTED AND APPROVED PRIOR TO COMMENCING WORK.
 - WHEN NECESSARY, AND JUSTIFIED, SINGLE LANES OF TRAFFIC MAY BE CLOSED DURING SPECIFIED HOURS OF THE DAY. THE DETERMINATION OF THESE HOURS SHALL BE IN CONSULTATION WITH AND SUBJECT TO THE APPROVAL OF THE CITY TRAFFIC ENGINEER AND PORT OF TACOMA. PROVIDED THAT LOCAL ACCESS IS MAINTAINED AT ALL TIMES WITH A MINIMUM OF A 12-FOOT WIDE ACCESS LANE FOR EACH DIRECTION OF TRAFFIC. THE CONTRACTOR SHALL COORDINATE ANY LANE CLOSURES AND COOPERATE WITH THE VARIOUS BUSINESSES AND/OR RESIDENCES ADJACENT TO THE PROJECT SITE. A MINIMUM OF ONE ACCESS SHALL BE MAINTAINED TO ALL PROPERTIES AND DRIVEWAYS ON ALEXANDER AVENUE AT ALL TIMES.
- THREE (3) WORKING DAYS PRIOR TO ANY LANE CLOSURE, THE CONTRACTOR SHALL NOTIFY:
- | | |
|---|-----------------------|
| TACOMA PUBLIC WORKS ENGINEERING DIVISION | (253-591-5500) |
| TACOMA PUBLIC WORKS STREETS AND GROUNDS | (253-591-5495) |
| TACOMA PUBLIC WORKS SOLID WASTE | (253-591-5544) |
| TACOMA FIRE DEPARTMENT | (253-591-5733) |
| TACOMA POLICE DEPARTMENT | (253-591-5951) |
| LESA COMMUNICATION CENTER | (253-798-4721-Opt.#3) |
| TACOMA PUBLIC SCHOOLS TRANSPORTATION OFFICE | (253-571-1853) |
| PIERCE TRANSIT | (253-581-8109) |

GENERAL CONSTRUCTION SEQUENCE:

- ARRANGE NECESSARY PRE-CONSTRUCTION MEETINGS WITH THE CITY OF TACOMA CONSTRUCTION DIVISION AND BUILDING AND LAND USE SERVICE, TACOMA POWER, TACOMA WATER, ARCHITECT, AND ENGINEER.
- STAKE PROJECT LIMITS PRIOR TO BEGINNING CONSTRUCTION.
- NOTIFY CITY INSPECTOR IN WRITING ABOUT SCHEDULED UTILITY AND ROAD CLOSURES AT LEAST 14 DAYS PRIOR TO CONSTRUCTION.
- DAMAGE TO ANY OF THE PUBLIC UTILITIES AS A RESULT OF THE CONSTRUCTION OF THIS PROJECT SHALL BE REPAIRED BY THE CONTRACTOR.
- INSTALL ALL APPLICABLE TESC FACILITIES. MAINTAIN ALL TESC FACILITIES DURING THE LENGTH OF THE CONSTRUCTION PROCESS. ADDITIONAL FACILITIES MAY BE REQUIRED AS FIELD CONDITIONS WARRANT.
- INSTALL ALL NEW PAVEMENT, CHANNELIZATION AND SIGNAGE.
- DEMOLISH EXISTING PAVEMENT.
- REMOVE TESC FACILITIES ONLY AFTER OBTAINING FINAL APPROVAL FROM CITY INSPECTOR.
- TRAFFIC TO REMAIN OPEN ON ALEXANDER AVENUE DURING CONSTRUCTION.

ELEVATION DATUM

VERTICAL DATUM: CITY OF TACOMA (NGVD 29)
BENCHMARK: 3 INCH BRASS DISK ON MILWAUKEE WAY,
SOUTH OF E. 11TH AVENUE.
BENCHMARK NO. 2863
ELEVATION = 12.117'

BASIS OF BEARING

BASIS OF BEARINGS FOR THIS SURVEY IS THE CITY OF TACOMA DATUM, NAD 83(91) WASHINGTON SOUTH ZONE (4602).

GENERAL SURVEY NOTE

SURVEY OUTSIDE OF THE RIGHT OF WAY PROJECT LIMITS SHOWN AS BACKGROUND INFORMATION.

SHEET INDEX:

- COVER SHEET
- SURVEY
- SURVEY
- DEMOLITION AND TESC PLAN
- DEMOLITION AND TESC NOTES AND DETAILS
- PAVING PLAN
- DRIVEWAY SECTION
- CHANNELIZATION AND SIGNAGE PLAN
- CHANNELIZATION AND SIGNAGE DETAILS
- GENERAL NOTES

PROJECT CONTACT INFORMATION

OWNER - PORT OF TACOMA	UTILITY	REGULATORY AGENCY	CONTACT	PHONE NUMBER
STAN RYTER, SENIOR PROJECT MANAGER EMAIL: sryter@portoftacoma.com	STORM WATER SANITARY SEWER POWER WATER	CITY OF TACOMA CITY OF TACOMA TACOMA POWER TACOMA WATER	ENVIRONMENTAL SERVICES ENVIRONMENTAL SERVICES JOHN MARTINSEN KAREN GERKEN GRANT WHITLEY TERRY BRENTIN JOY BATEMAN MARTIN MCELROY CARL ANDERSON LARRY CRISWELL	(253) 591-5588 (253) 591-5588 (253) 502-8659 (253) 502-8736 (253) 502-8746 (253) 502-6242 (253) 597-5100 (253) 845-4867 (253) 591-5503 (253) 591-5787
ENGINEER - KPFF CONSULTING ENGINEERS SCOTT KUEBLER, PROJECT MANAGER STEVE KINGSLEY, PROJECT ENGINEER PHONE: (253) 396-0150 EMAIL: scott.kuebler@kpff.com steve.kingsley@kpff.com	GAS TELEPHONE CABLE FIRE PROTECTION CONST.	PSE/PILCHUCK AT&T BROADBAND CITY OF TACOMA CITY OF TACOMA		

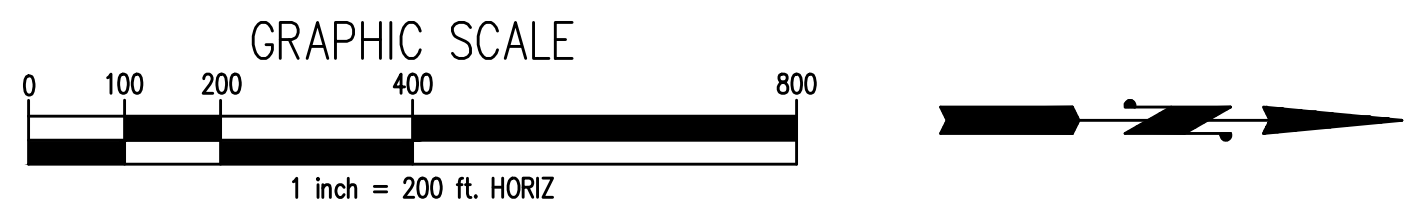
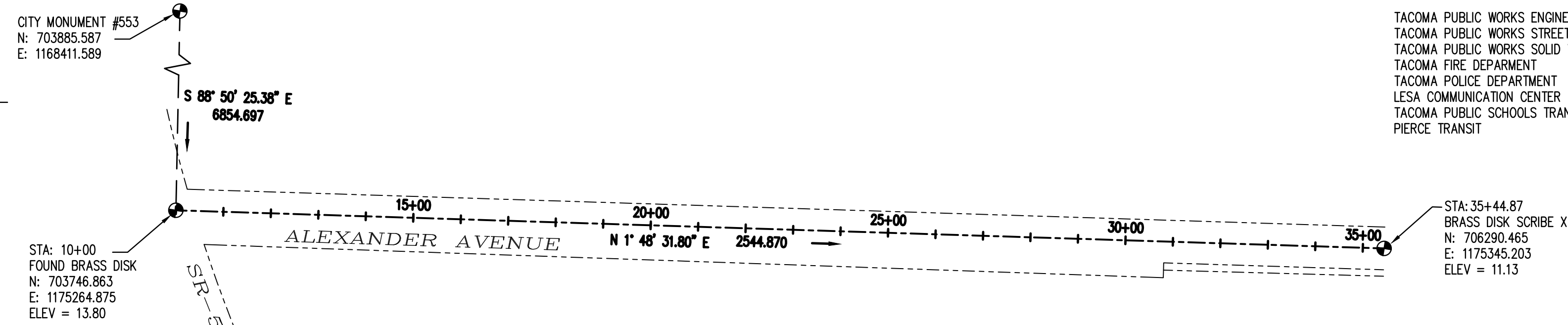

kpff
2407 North 31st Street, Suite 100
Tacoma, Washington 98407
(253) 396-0150 Fax (253) 396-0162

CALL 48 HOURS
BEFORE YOU DIG
1-800-424-5555



NO	REVISION	DATE	APPD

FINAL CONSTRUCTION CHECKED	DATE	SCALE
	06/18/20	AS SHOWN
BY	CHECKED	PROJECT NAME
	CMB	SWK
DATE	DRAWN	
	RRL	
FIELD BOOKS	DRAWING NAME	

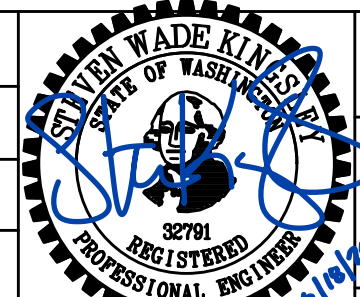

SITE AND BUILDING DIVISION

CITY OF TACOMA
DEPARTMENT OF PUBLIC WORKS
ALEXANDER AVE DRIVEWAY IMPROVEMENTS
4215 SR 509
COVER SHEET

WO19-0155
SHEET NO.
SHEET 1 OF 10

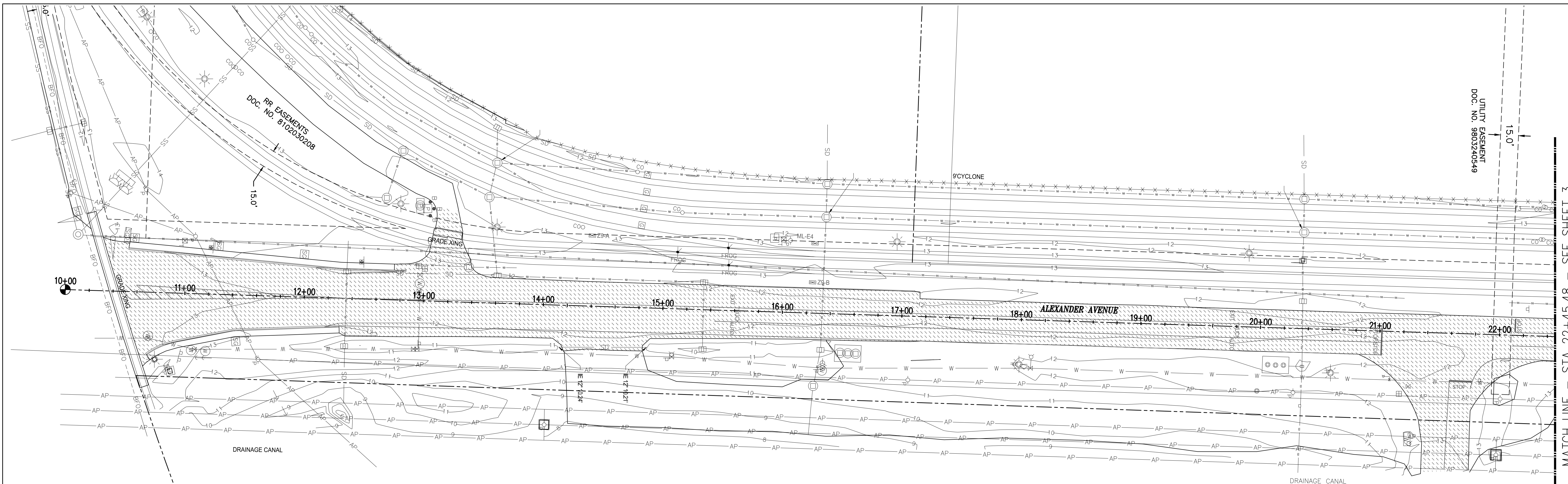

UTILITY EASEMENT
DOC. NO. 9803240349

RR EASEMENTS
DOC. NO. 810230208

MATCH LINE - STA 22+45.48 - SEE SHEET 3

LEGEND:

—	CURB LINE	o o o	STORM CLEAN OUT
---	EDGE OF ASPHALT	①	TELECOMMUNICATIONS MANHOLE
---	BFO FIBER OPTIC LINE	⌈	TELECOMMUNICATIONS VAULT
---	BP ELECTRICAL LINE	⌈	TELECOMMUNICATIONS RISER
---	BT TELECOMMUNICATIONS LINE	⌈	TRAFFIC SIGNAL BOX
---	SD STORM LINE	⌈	TRAFFIC SIGNAL CABINET
---	SS SANITARY SEWER LINE	⌈	TRAFFIC CONTROL SIGNAL ARM
---	W WATER LINE	⌈	WATER METER
---	GAS LINE	⌈	FIRE HYDRANT
---	CYCLONE FENCE LINE	⌈	WATER VAULT
---	OVERHEAD UTILITY LINES	⌈	WATER VALVE
•	SIGN	⌈	WATER MANHOLE
•	BOLLARD	⌈	HOSE BIB
Ⓜ	MAILBOX	⌈	FIRE DEPARTMENT CONNECT
Ⓜ	ELECTRICAL MANHOLE	⌈	POST INDICATOR VALVE
Ⓜ	ELECTRICAL METER	⌈	TRAIN ID SCANNER
Ⓜ	ELECTRICAL RISER	⌈	AEI READER
Ⓜ	ELECTRICAL CABINET	⌈	UNKNOWN UTILITY VAULT
Ⓜ	ELECTRICAL VAULT	⌈	DECIDUOUS TREE
Ⓜ	TRANSFORMER	⌈	-PERIMETER REPRESENTS DRIPLINE
⌈	GUY ANCHOR	⌈	CONIFEROUS TREE
⌈	GUY POLE	⌈	-PERIMETER REPRESENTS DRIPLINE
⌈	GROUND FLOOD LIGHT	⌈	WIND STOCK FLAG
⌈	LIGHT J-BOX	⌈	RAILROAD GREASEBOX
⌈	OVERHEAD LIGHT	⌈	RAILROAD AUTO SWITCH/NUMBER
⌈	POWER POLE/OVERHEAD LIGHT	⌈	RAILROAD MANUAL SWITCH/NUMBER
⌈	POWER POLE W/DROP	⌈	RAILROAD FROG
⌈	POWER POLE	⌈	RAILROAD SIGN
⌈	GAS MARKER POST	⌈	RAILROAD CROSSING SIGNAL
⌈	GAS VAULT		
⌈	GAS VALVE		
⌈	SANITARY MANHOLE WITH STRUCTURE		
⌈	STORM MANHOLE WITH STRUCTURE		
⌈	CATCH BASIN/AREA DRAIN		

NOTES:

- 1.) VERTICAL DATUM: CITY OF TACOMA (NGVD 29)
BENCHMARK: 3 INCH BRASS DISK ON MILWAUKEE WAY, SOUTH OF E. 11TH AVENUE.
BENCHMARK NO. 2863
ELEVATION = 12.117'
- 2.) BASIS OF BEARINGS FOR THIS SURVEY IS THE CITY OF TACOMA DATUM, NAD 83(91)
WASHINGTON SOUTH ZONE (4602).
- 3.) UTILITY LOCATIONS SHOWN ARE PER FIELD LOCATED UTILITY PAINT MARKS & REFERENCE
MAPS MADE AVAILABLE BY THE VARIOUS UTILITY PROVIDERS. UNLESS INDICATED, DEPTHS OF
UTILITY LINES ARE NOT AVAILABLE. ALL UTILITY LOCATIONS SHOULD BE FIELD VERIFIED
PRIOR TO CONSTRUCTION.
- 4.) BOUNDARY AND EASEMENTS SHOWN HEREON ARE BASED ON TITLE REPORT NUMBER
0048493-TC BY CHICAGO TITLE INSURANCE COMPANY, EFFECTIVE DATE OF 15 SEPTEMBER
2015.

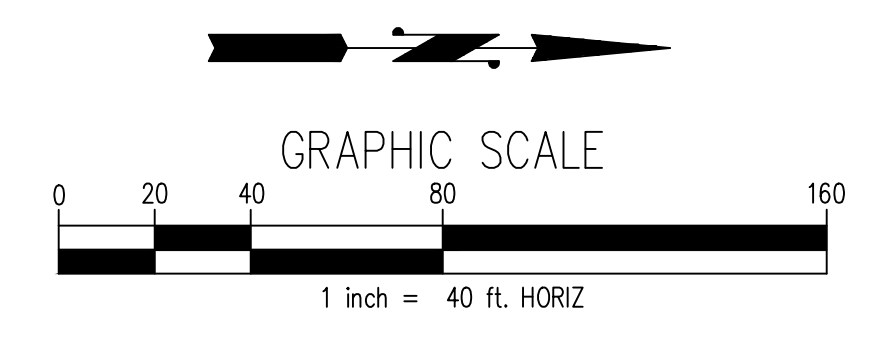

kpff
2407 North 31st Street, Suite 100
Tacoma, Washington 98407
(253) 396-0150 Fax (253) 396-0162

**CALL 48 HOURS
BEFORE YOU DIG
1-800-424-5555**



NO	REVISION	DATE	APPD

FINAL CONSTRUCTION CHECKED	DATE 06/18/20	SCALE AS SHOWN
BY CMB	CHECKED SWK	
DATE RRL	DRAWN PROJECT NAME	
FIELD BOOKS	DRAWING NAME	

CITY OF TACOMA DEPARTMENT OF PUBLIC WORKS		
ALEXANDER AVE DRIVEWAY IMPROVEMENTS		WO19-0155
4215 SR 509		SHEET NO.
SURVEY		SHEET 2 OF 10

MATCH LINE - STA 22+45.48 - SEE SHEET 2

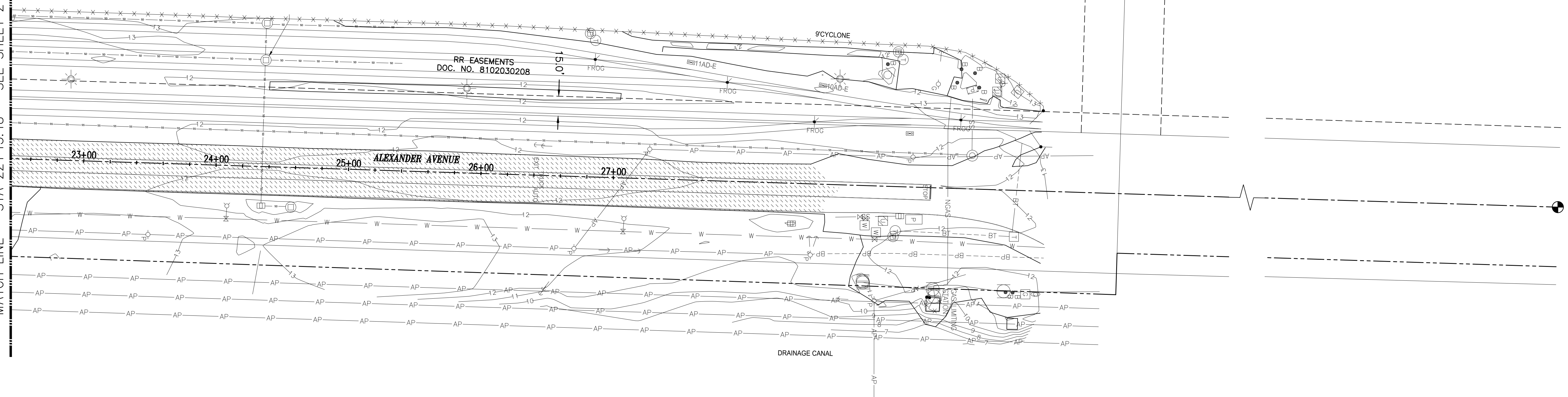

LEGEND:

—	CURB LINE	o o o	STORM CLEAN OUT
—	EDGE OF ASPHALT	①	TELECOMMUNICATIONS MANHOLE
---	BFO FIBER OPTIC LINE	Ⓜ	TELECOMMUNICATIONS VAULT
---	BP ELECTRICAL LINE	Ⓜ	TELECOMMUNICATIONS RISER
---	BT TELECOMMUNICATIONS LINE	Ⓜ	TRAFFIC SIGNAL BOX
---	SD STORM LINE	Ⓜ	TRAFFIC SIGNAL CABINET
---	SS SANITARY SEWER LINE	Ⓜ	TRAFFIC CONTROL SIGNAL ARM
---	W WATER LINE	Ⓜ	WATER METER
---	GAS LINE	Ⓜ	FIRE HYDRANT
---	CYCLONE FENCE LINE	Ⓜ	WATER VAULT
---	OVERHEAD UTILITY LINES	Ⓜ	WATER VALVE
⊙	SIGN	Ⓜ	WATER MANHOLE
●	BOLLARD	Ⓜ	HOSE BIB
Ⓜ	MAILBOX	Ⓜ	FIRE DEPARTMENT CONNECT
Ⓜ	ELECTRICAL MANHOLE	Ⓜ	POST INDICATOR VALVE
Ⓜ	ELECTRICAL METER	Ⓜ	TRAIN ID SCANNER
Ⓜ	ELECTRICAL RISER	Ⓜ	AEI READER
Ⓜ	ELECTRICAL CABINET	Ⓜ	UNKNOWN UTILITY VAULT
Ⓜ	ELECTRICAL VAULT	Ⓜ	DECIDUOUS TREE
Ⓜ	TRANSFORMER	Ⓜ	-PERIMETER REPRESENTS DRIPLINE
Ⓜ	GUY ANCHOR	Ⓜ	CONIFEROUS TREE
Ⓜ	GUY POLE	Ⓜ	-PERIMETER REPRESENTS DRIPLINE
Ⓜ	GROUND FLOOD LIGHT	Ⓜ	WIND STOCK FLAG
Ⓜ	LIGHT J-BOX	Ⓜ	RAILROAD GREASEBOX
Ⓜ	OVERHEAD LIGHT	Ⓜ	RAILROAD AUTO SWITCH/NUMBER
Ⓜ	POWER POLE/OVERHEAD LIGHT	Ⓜ	RAILROAD MANUAL SWITCH/NUMBER
Ⓜ	POWER POLE W/DROP	Ⓜ	RAILROAD FROG
Ⓜ	POWER POLE	Ⓜ	RAILROAD SIGN
Ⓜ	GAS MARKER POST	Ⓜ	RAILROAD CROSSING SIGNAL
Ⓜ	GAS VAULT		
Ⓜ	GAS VALVE		
Ⓜ	SANITARY MANHOLE WITH STRUCTURE		
Ⓜ	STORM MANHOLE WITH STRUCTURE		
Ⓜ	CATCH BASIN/AREA DRAIN		

NOTES:

- 1.) VERTICAL DATUM: CITY OF TACOMA (NGVD 29)
BENCHMARK: 3 INCH BRASS DISK ON MILWAUKEE WAY, SOUTH OF E. 11TH AVENUE.
BENCHMARK NO. 2863
ELEVATION = 12.117'
- 2.) BASIS OF BEARINGS FOR THIS SURVEY IS THE CITY OF TACOMA DATUM, NAD 83(91) WASHINGTON SOUTH ZONE (4602).
- 3.) UTILITY LOCATIONS SHOWN ARE PER FIELD LOCATED UTILITY PAINT MARKS & REFERENCE MAPS MADE AVAILABLE BY THE VARIOUS UTILITY PROVIDERS. UNLESS INDICATED, DEPTHS OF UTILITY LINES ARE NOT AVAILABLE. ALL UTILITY LOCATIONS SHOULD BE FIELD VERIFIED PRIOR TO CONSTRUCTION.
- 4.) BOUNDARY AND EASEMENTS SHOWN HEREON ARE BASED ON TITLE REPORT NUMBER 0048493-TC BY CHICAGO TITLE INSURANCE COMPANY, EFFECTIVE DATE OF 15 SEPTEMBER 2015.

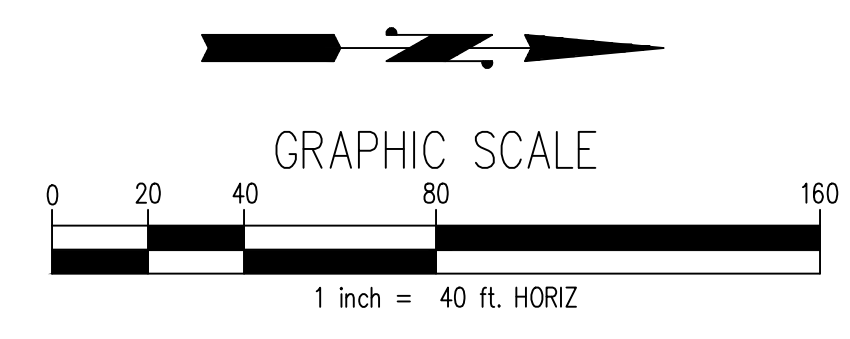

kpff
2407 North 31st Street, Suite 100
Tacoma, Washington 98407
(253) 396-0150 Fax (253) 396-0162

**CALL 48 HOURS
BEFORE YOU DIG
1-800-424-5555**



NO	REVISION	DATE	APPD
----	----------	------	------

FINAL CONSTRUCTION CHECKED	DATE	SCALE
	06/18/20	AS SHOWN
DESIGNED	CHECKED	
CMB	SWK	
DRAWN	PROJECT NAME	
RRL	ALEXANDER AVE DRIVEWAY IMPROVEMENTS	
FIELD BOOKS	DRAWING NAME	

CITY OF TACOMA
DEPARTMENT OF PUBLIC WORKS

ALEXANDER AVE DRIVEWAY IMPROVEMENTS
4215 SR 509
SURVEY

WO19-0155
SHEET NO.
SHEET 3 OF 10

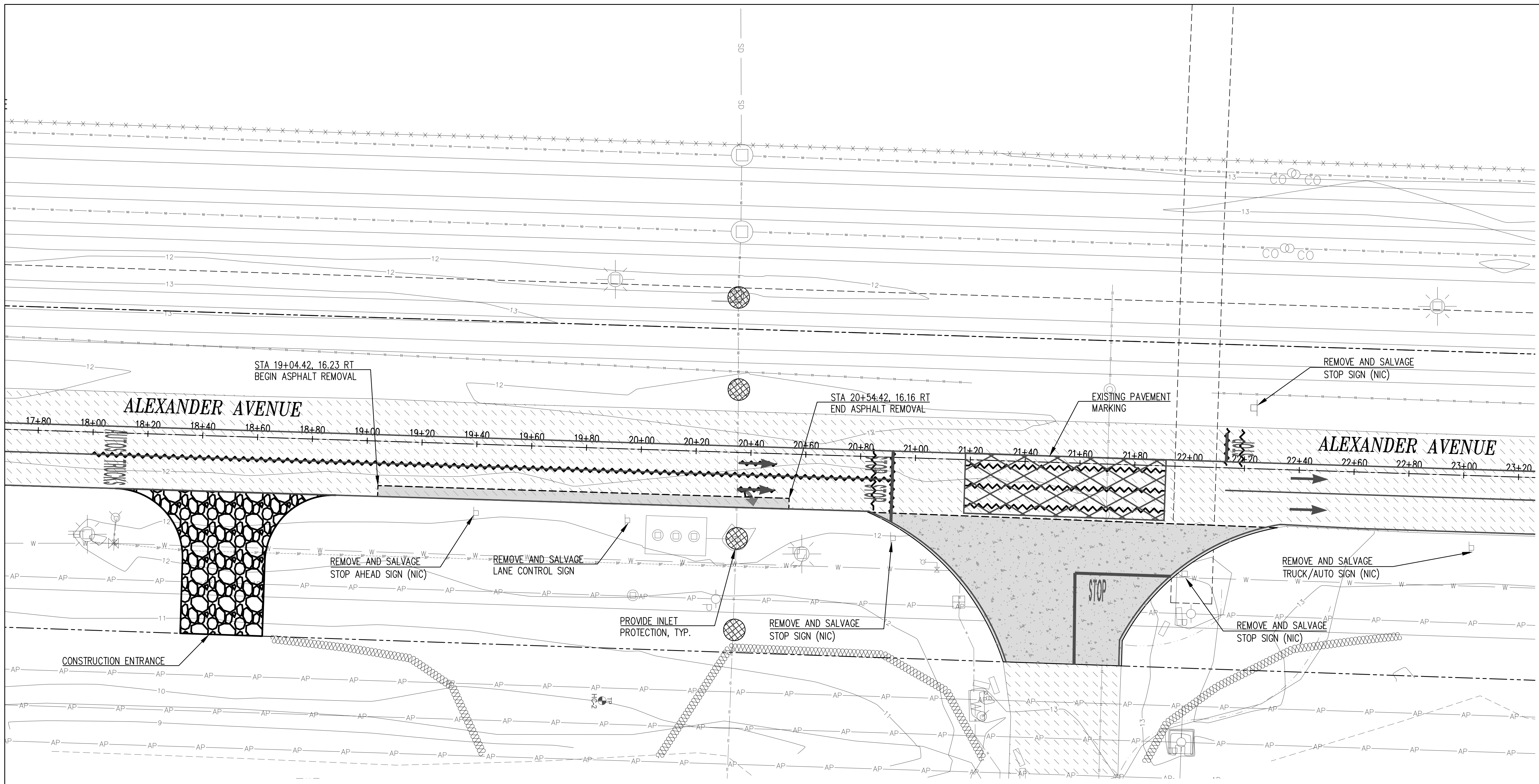



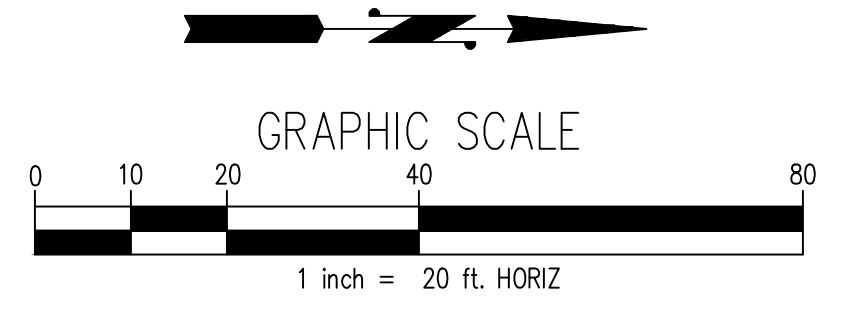

PLAN

SCALE: 1" = 20'

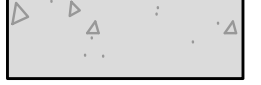

LEGEND

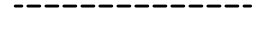
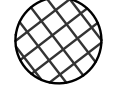
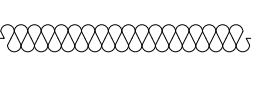
-  EXISTING ASPHALT ROADWAY
-  REMOVE DRIVEWAY APPROACH
-  REMOVE ASPHALT
-  CONSTRUCTION ENTRANCE (3/5)
-  REMOVE PAVEMENT MARKING
-  SAWCUT
-  CATCH BASIN INLET PROTECTION. CONTRACTOR TO INSURE ANY CATCH BASIN DOWNSTREAM OF THE PROJECT LIMITS (WITHIN 500') HAS INLET PROTECTION FOR THE DURATION OF CONSTRUCTION. (1/5)
-  STRAW WATTLES (2/5)

kpff
 2407 North 31st Street, Suite 100
 Tacoma, Washington 98407
 (253) 396-0150 Fax (253) 396-0162

**CALL 48 HOURS
 BEFORE YOU DIG
 1-800-424-5555**



NO	REVISION	DATE	APPD

FINAL CONSTRUCTION CHECKED	DATE	SCALE
	06/18/20	AS SHOWN
DESIGNED	CHECKED	PROJECT NAME
CMB	SWK	ALEXANDER AVE DRIVEWAY IMPROVEMENTS
DRAWN	PROJECT NAME	
RRL		
FIELD BOOKS	DRAWING NAME	

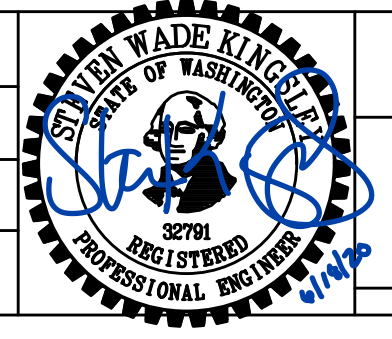

SITE AND BUILDING DIVISION

CITY OF TACOMA
 DEPARTMENT OF PUBLIC WORKS
ALEXANDER AVE DRIVEWAY IMPROVEMENTS
 4215 SR 509
 DEMOLITION AND TESC PLAN

WO19-0155
 SHEET NO.
 SHEET 4 OF 10

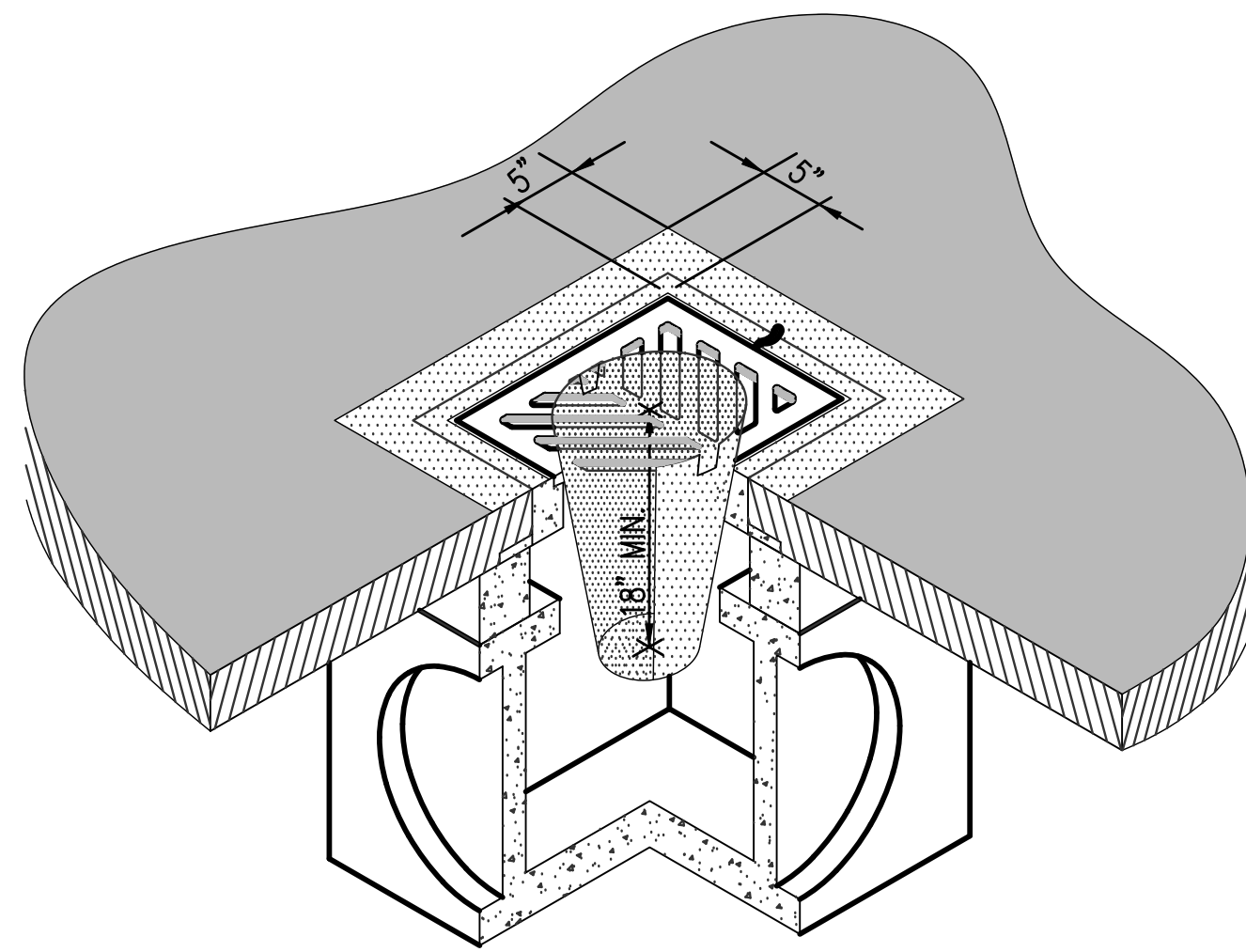

NOTES:

1. INSERT SHALL BE INSTALLED IN ALL OPERATIONAL CATCH BASINS WITHIN 500 FEET OF WORK LIMITS PRIOR TO CLEARING AND GRADING ACTIVITY, OR UPON PLACEMENT OF A NEW CATCH BASIN.
2. FILTERS SHALL BE INSPECTED AFTER EACH STORM EVENT AND CLEANED OR REPLACED WHEN IT IS 1/3 FULL.
3. SEDIMENT REMOVAL SHALL BE ACCOMPLISHED BY REMOVING THE INSERT, EMPTYING INTO APPROPRIATE DISPOSAL LOCATION, AND REINSERTING IT INTO THE CATCH BASIN.

INLET PROTECTION DETAIL

SCALE: NTS

1
4

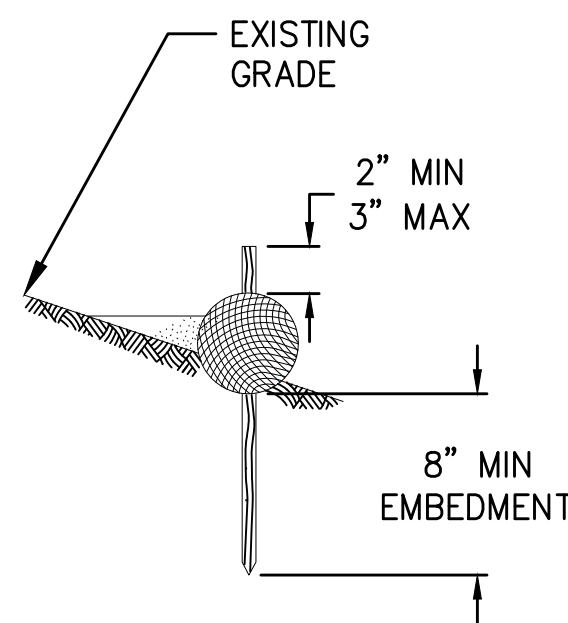

STRAW WATTLE DETAIL

SCALE: NTS

2
4

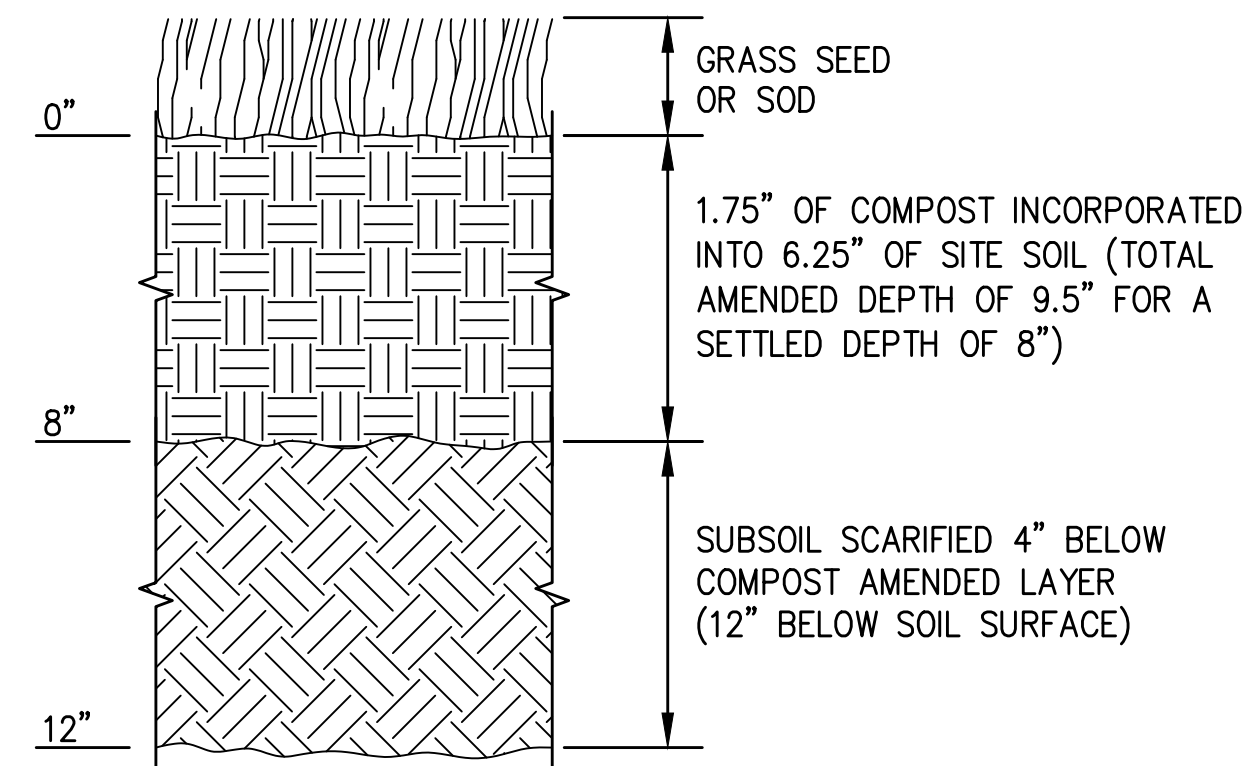

NOTES:

1. AMEND EXISTING SITE TOPSOIL OR SUBSOIL EITHER AT PRE-APPROVED RATE OR AT CALCULATED RATE BASED ON TEST OF THE SOIL AND AMENDMENTS. ALL SOIL AREAS DISTURBED OR COMPACTED DURING CONSTRUCTION, AND NOT COVERED BY BUILDINGS OR PAVEMENT, SHALL BE AMENDED WITH COMPOST AS DESCRIBED BELOW.
2. SCARIFY OR TILL SUBGRADE TO 8 INCHES DEPTH (OR TO DEPTH NEEDED TO ACHIEVE A TOTAL DEPTH OF 12 INCHES OF UNCOMPACTED SOIL AFTER CALCULATED AMOUNT OF AMENDMENT IS ADDED). ENTIRE SURFACE SHOULD BE DISTURBED BY SCARIFICATION. DO NOT SCARIFY WITHIN DRIP LINE OF EXISTING TREES TO BE RETAINED OR WHERE SCARIFICATION WOULD DAMAGE TREE ROOTS OR AS DETERMINED BY THE ENGINEER.
3. PREAPPROVED RATE:
PLACE 1.75 INCHES OF COMPOSTED MATERIAL AND ROTOTILL INTO 6.25 INCHES OF EXISTING SITE SOILS (A TOTAL AMENDED DEPTH OF ABOUT 9.5 INCHES, FOR A SETTLED DEPTH OF 8 INCHES).
4. CALCULATED RATE:
PLACE CALCULATED AMOUNT OF COMPOSTED MATERIAL OR APPROVED ORGANIC MATERIAL AND ROTOTILL INTO DEPTH OF SOIL NEEDED TO ACHIEVE 8 INCHES OF SETTLED SOIL AT 5% ORGANIC CONTENT.
5. WATER OR ROLL TO COMPACT TO 85% OF MAXIMUM DRY DENSITY. RAKE TO LEVEL AND REMOVE SURFACE ROCKS LARGER THAN 1 INCH DIAMETER.
6. TO PREVENT UNEVEN SETTLING, DO NOT COMPOST-AMEND SOILS WITHIN 3 FEET ON CENTER OF UTILITY INFRASTRUCTURE (POLES, VAULTS, METERS ETC. WITHIN ONE FOOT OF PAVEMENT EDGE, CURBS AND SIDEWALKS); SOIL SHOULD BE COMPACTED TO 90% MAX MODIFIED PROCTOR DENSITY (ASTM D1557) TO ENSURE A FIRM SURFACE.

DISTURBED AREA SOIL AMENDMENT

SCALE: NTS

4
4

DEMOLITION NOTES:

1. EXTENTS OF ASPHALT REMOVAL ARE APPROXIMATE, ACTUAL REMOVAL LIMITS WILL BE DELINEATED BY A CONSTRUCTION DIVISION INSPECTOR
2. ALL DIMENSIONS ARE TO FACE OF CURB OR EDGE OF PAVEMENT UNLESS OTHERWISE NOTED.
3. DISTURBED AREAS WHICH ARE RESTORED AS LAWN OR AS VEGETATED AREAS, SHALL BE COVERED WITH TOPSOIL AND MULCH IN ACCORDANCE WITH BEST MANAGEMENT PRACTICE L613 OF THE CITY OF TACOMA 2016 STORMWATER MANAGEMENT MANUAL.
4. SITE FURNISHINGS ENCOUNTERED IN THE PUBLIC ROW (CONCRETE PLANTERS, BIKE RACKS, TRASH CANS, ETC.) & IDENTIFIED ON THIS PLAN SHALL BE OFFERED TO THE OWNER (CITY OF TACOMA) FOR SALVAGE PRIOR TO DISPOSAL. IF DECLINED BY THE OWNER (CITY OF TACOMA), ALL DEMOLISHED ITEMS SHALL BE DISPOSED OF OFF SITE BY THE CONTRACTOR

EROSION & SEDIMENT CONTROL NOTES:

1. APPROVAL OF THIS EROSION/SEDIMENTATION CONTROL (ESC) PLAN DOES NOT CONSTITUTE AN APPROVAL OF PERMANENT ROAD OR DRAINAGE DESIGN (E.G. SIZE AND LOCATION OF ROADS, PIPES, RESTRICTORS, CHANNELS, RETENTION FACILITIES, UTILITIES, ETC.).
2. THE IMPLEMENTATION OF THESE ESC PLANS AND THE CONSTRUCTION, MAINTENANCE, REPLACEMENT AND UPGRADING OF THESE ESC FACILITIES IS THE RESPONSIBILITY OF THE APPLICANT/CONTRACTOR UNTIL ALL CONSTRUCTION IS COMPLETED AND APPROVED AND VEGETATION/LANDSCAPING IS ESTABLISHED. AT THE DISCRETION OF PORT ENVIRONMENTAL STAFF SWPP MEASURES OBSERVED AS INADEQUATE WILL BE BROUGHT TO THE CONTRACTORS ATTENTION FOR REVISION/MODIFICATION. PORT ENVIRONMENTAL STAFF; ANITA FICHTHORN (253) 495-2834, AFICHTHORN@NWSEAPORTALLIANCE.COM
3. THE BOUNDARIES OF THE CLEARING LIMITS SHOWN ON THIS PLAN SHALL BE CLEARLY FLAGGED IN THE FIELD PRIOR TO CONSTRUCTION. DURING THE CONSTRUCTION PERIOD, NO DISTURBANCE BEYOND THE FLAGGED CLEARING LIMITS SHALL BE PERMITTED. THE FLAGGING SHALL BE MAINTAINED BY THE APPLICANT/CONTRACTOR FOR THE DURATION OF CONSTRUCTION.
4. THE ESC FACILITIES SHOWN ON THIS PLAN MUST BE CONSTRUCTED IN CONJUNCTION WITH ALL CLEARING AND GRADING ACTIVITIES, AND IN SUCH A MANNER AS TO ENSURE THAT SEDIMENT AND SEDIMENT LADEN WATER DO NOT ENTER THE DRAINAGE SYSTEM OR ROADWAYS, OR VIOLATE APPLICABLE WATER STANDARDS.
5. THE ESC FACILITIES SHOWN ON THIS PLAN ARE THE MINIMUM REQUIREMENTS FOR ANTICIPATED SITE CONDITIONS. DURING THE CONSTRUCTION PERIOD, THESE ESC FACILITIES SHALL BE UPGRADED AS NEEDED FOR UNEXPECTED STORM EVENTS AND TO ENSURE THAT SEDIMENT AND SEDIMENT-LADEN WATER DO NOT LEAVE THE SITE.
6. THE ESC FACILITIES SHALL BE INSPECTED DAILY BY THE APPLICANT/CONTRACTOR AND MAINTAINED AS NECESSARY TO ENSURE THEIR CONTINUED FUNCTIONING.
7. THE ESC FACILITIES ON INACTIVE SITES SHALL BE INSPECTED AND MAINTAINED A MINIMUM OF ONCE A MONTH OR WITHIN THE 48 HOURS FOLLOWING A STORM EVENT.
8. ALL CATCH BASINS AND CONVEYANCE LINES SHALL BE CLEANED PRIOR TO PAVING. THE CLEANING OPERATION SHALL NOT FLUSH SEDIMENT-LADEN WATER INTO THE DOWNSTREAM SYSTEM.
9. STABILIZED CONSTRUCTION ENTRANCES SHALL BE INSTALLED AT THE BEGINNING OF CONSTRUCTION AND MAINTAINED FOR THE DURATION OF THE PROJECT. ADDITIONAL MEASURES MAY BE REQUIRED TO ENSURE THAT ALL PAVED AREAS ARE KEPT CLEAN FOR THE DURATION OF THE PROJECT.
10. IF DEWATERING IS ANTICIPATED OR ENCOUNTERED DURING CONSTRUCTION, THE CONTRACTOR SHALL CONTACT A SOURCE CONTROL REPRESENTATIVE WITH THE CITY OF TACOMA AT 253-591-5588.

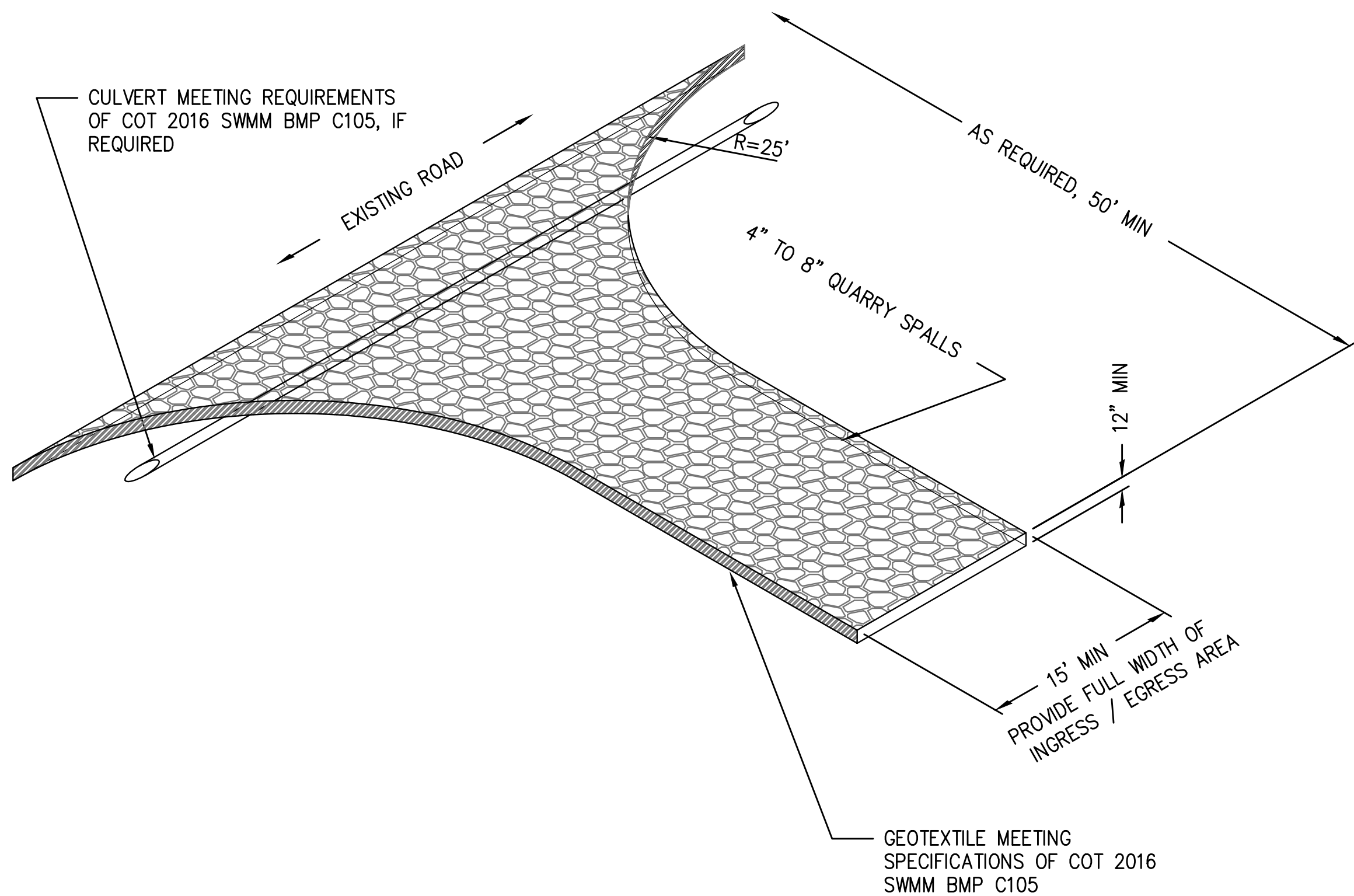

MAINTENANCE STANDARDS:

1. QUARRY SPALLS SHALL BE ADDED IF THE PAD IS NO LONGER IN ACCORDANCE WITH THE SPECIFICATIONS.
2. IF THE ENTRANCE IS NOT PREVENTING SEDIMENT FROM BEING TRACKED ONTO PAVEMENT, THEN ALTERNATIVE MEASURES TO KEEP THE STREETS FREE OF SEDIMENT SHALL BE USED. THIS MAY INCLUDE STREET SWEEPING, AN INCREASE IN THE DIMENSIONS OF THE ENTRANCE, OR THE INSTALLATION OF A WHEEL WASH. IF WASHING IS USED, IT SHALL BE DONE ON AN AREA COVERED WITH CRUSHED ROCK, AND WASH WATER SHALL DRAIN TO A SEDIMENT TRAP OR POND.
3. ANY SEDIMENT THAT IS TRACKED ONTO PAVEMENT SHALL BE REMOVED IMMEDIATELY BY SWEEPING. THE SEDIMENT COLLECTED BY SWEEPING SHALL BE REMOVED OR STABILIZED ON-SITE. THE PAVEMENT SHALL NOT BE CLEANED BY WASHING DOWN THE STREET, EXCEPT WHEN SWEEPING IS INEFFECTIVE AND THERE IS A THREAT TO PUBLIC SAFETY. IF IT IS NECESSARY TO WASH THE STREETS, THE CONSTRUCTION OF A SMALL SUMP SHALL BE CONSIDERED. THE SEDIMENT WOULD THEN BE WASHED INTO THE SUMP.
4. ANY QUARRY SPALLS THAT ARE LOOSENED FROM THE PAD AND END UP ON THE ROADWAY SHALL BE REMOVED IMMEDIATELY.
5. IF VEHICLES ARE ENTERING OR EXITING THE SITE AT POINTS OTHER THAN THE CONSTRUCTION ENTRANCE(S), FENCING SHALL BE INSTALLED TO CONTROL TRAFFIC.

CONSTRUCTION ENTRANCE DETAIL

SCALE: NTS

3
4

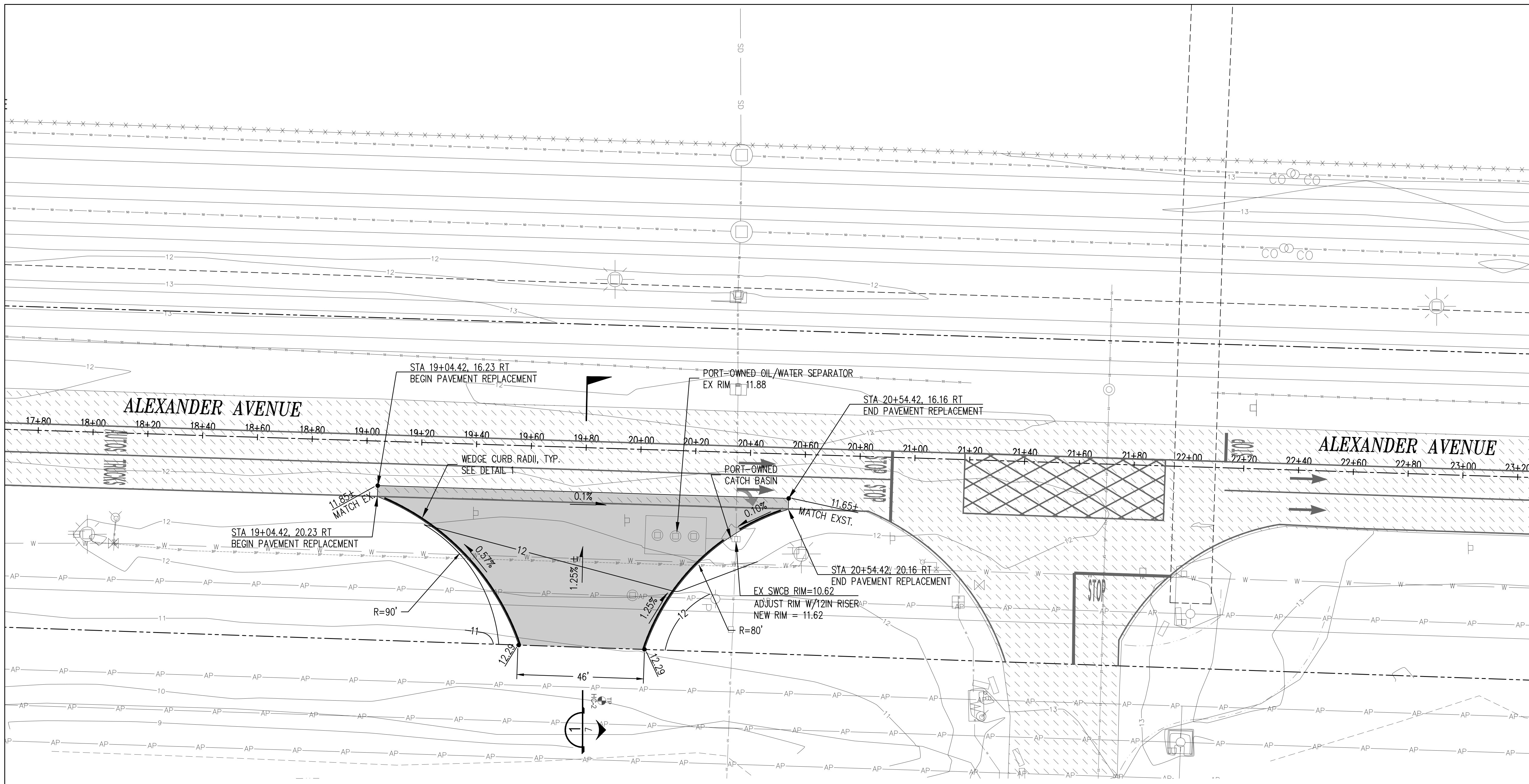

PLAN
SCALE: 1" = 20'

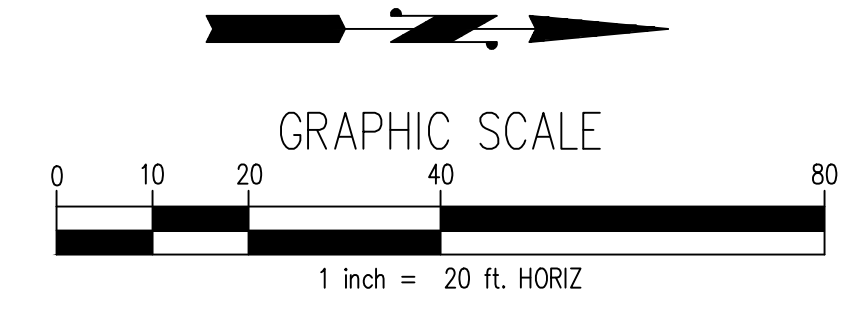

LEGEND

	EXISTING ASPHALT ROADWAY
	PROPOSED ASPHALT ROADWAY
	CENTERLINE
	RIGHT-OF-WAY LINE

GENERAL NOTES:

- FOR DRIVEWAY PAVEMENT SECTION SEE
- SEE SHEET 4 FOR STREET DEMOLITION PLANS.
- DISTURBED AREAS WHICH ARE RESTORED AS LAWN OR AS VEGETATED AREAS, SHALL BE COVERED WITH TOPSOIL AND MULCH IN ACCORDANCE WITH BEST MANAGEMENT PRACTICE L613 OF THE CITY OF TACOMA 2016 STORM WATER MANAGEMENT MANUAL.
- CONTRACTOR TO MATCH EXISTING GRADE AT SAWCUT LINE.
- SEE SHEET 8 FOR CHANNELIZATION.
- RESTORATION SHALL BE IN ACCORDANCE WITH THE CITY OF TACOMA RIGHT-OF-WAY RESTORATION POLICY. THE CITY INSPECTOR SHALL HAVE FINAL SAY FOR LIMITS OF RESTORATION.
- UTILITIES WITHIN RIGHT-OF-WAY ARE PUBLICLY OWNED UNLESS NOTED OTHERWISE.
- PROPOSED DRIVEWAY CROSSES AN EXISTING GAS MAIN OWNED BY PUGET SOUND ENERGY.
- ALL CATCH BASIN INLETS SHALL BE MARKED WITH "DUMP NO WASTE. DRAINS TO STREAM." OR "DUMP NO WASTE. DRAINS TO SOUND." STICKERS. CONTRACTOR SHALL INSTALL THE STICKERS PROVIDED BY THE CITY.

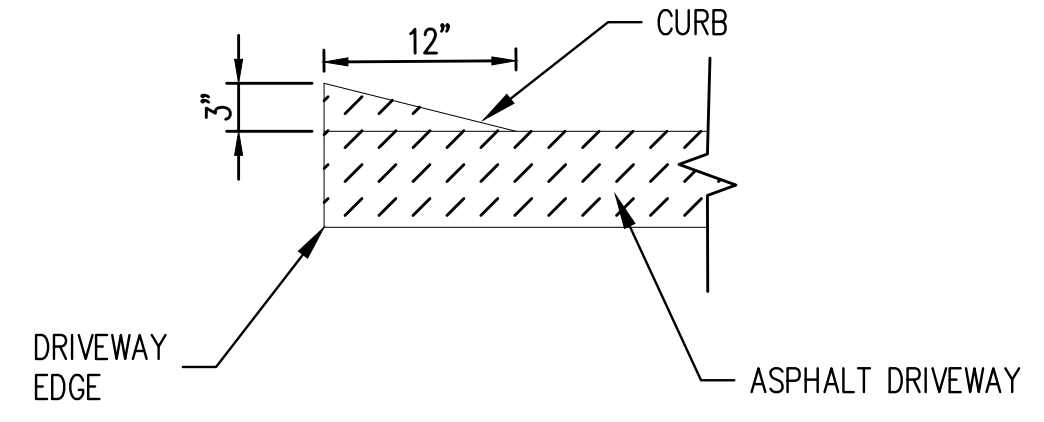

HMA WEDGE CURB
SCALE: NTS

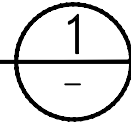

kpff
2407 North 31st Street, Suite 100
Tacoma, Washington 98407
(253) 396-0150 Fax (253) 396-0162

CALL 48 HOURS
BEFORE YOU DIG
1-800-424-5555

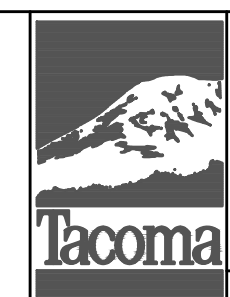

NO	REVISION	DATE	APPD

FINAL CONSTRUCTION CHECKED	DATE 06/18/20	SCALE AS SHOWN
DESIGNED CMB	CHECKED SWK	PROJECT NAME
DRAWN RRL	DRAWING NAME	
FIELD BOOKS		



SITE AND BUILDING DIVISION

CITY OF TACOMA
DEPARTMENT OF PUBLIC WORKS
ALEXANDER AVE DRIVEWAY IMPROVEMENTS
4215 SR 509
PAVING PLAN

WO19-0155
SHEET NO.
SHEET 6 OF 10

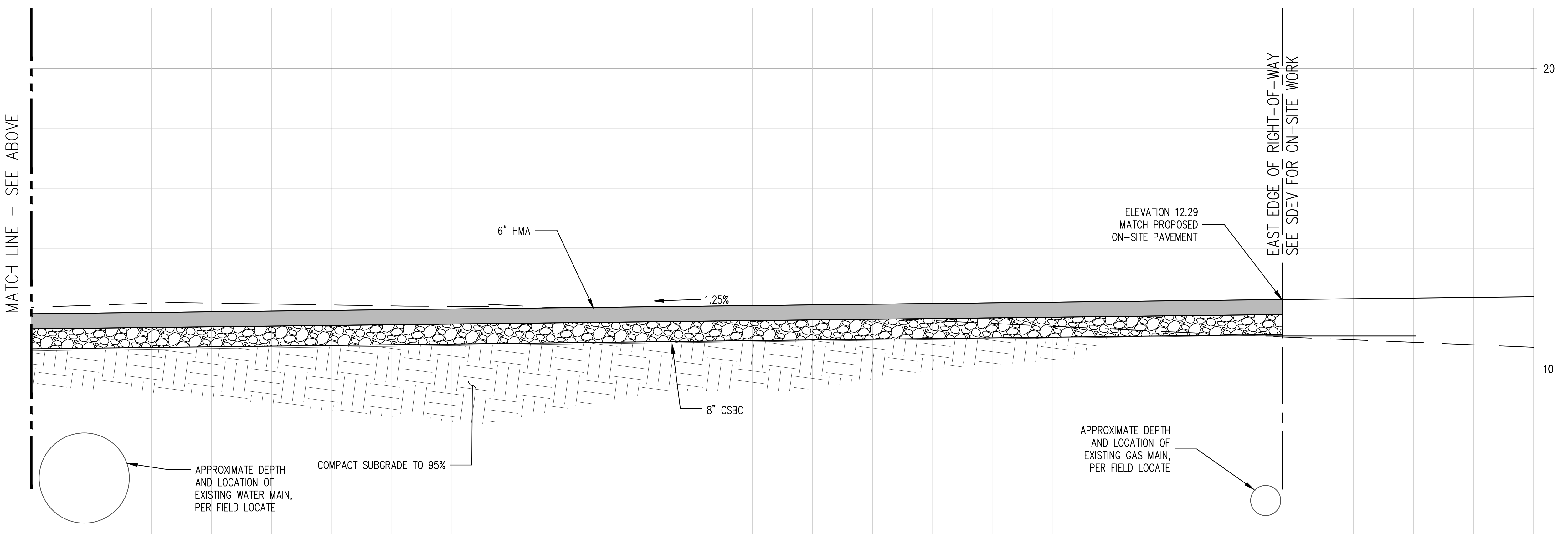
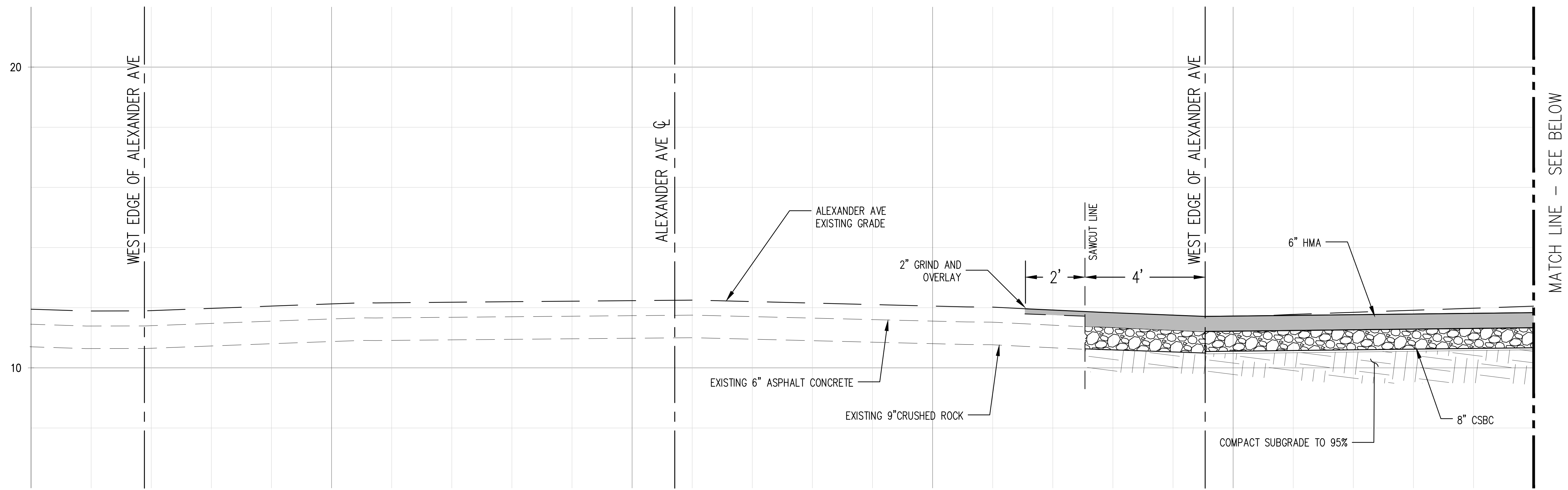

PAVEMENT SECTION CUT
NEW DRIVEWAY AREA

SCALE: 1" = 2'

1
6

- NOTES:
- RESTORATION SHALL BE IN ACCORDANCE WITH THE CITY OF TACOMA RIGHT-OF-WAY RESTORATION POLICY. THE CITY INSPECTOR SHALL HAVE FINAL SAY FOR LIMITS OF RESTORATION.
 - UTILITY LOCATIONS ARE APPROXIMATE AND NOT ALL-INCLUSIVE. CONTRACTOR TO LOCATE ALL UTILITIES PRIOR TO BEGINNING WORK.

kpff
2407 North 31st Street, Suite 100
Tacoma, Washington 98407
(253) 396-0150 Fax (253) 396-0162

CALL 48 HOURS
BEFORE YOU DIG
1-800-424-5555



NO	REVISION	DATE	APPD

FINAL CONSTRUCTION CHECKED	DATE	SCALE
	06/18/20	AS SHOWN
DESIGNED	CHECKED	
CMB	SWK	
DRAWN	PROJECT NAME	
RRL		
FIELD BOOKS	DRAWING NAME	

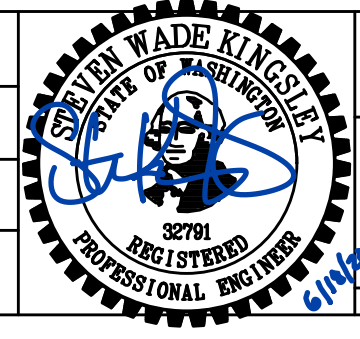

CITY OF TACOMA
DEPARTMENT OF PUBLIC WORKS
ALEXANDER AVE DRIVEWAY IMPROVEMENTS
4215 SR 509
DRIVEWAY SECTION

WO19-0155
SHEET NO.
SHEET 7 OF 10

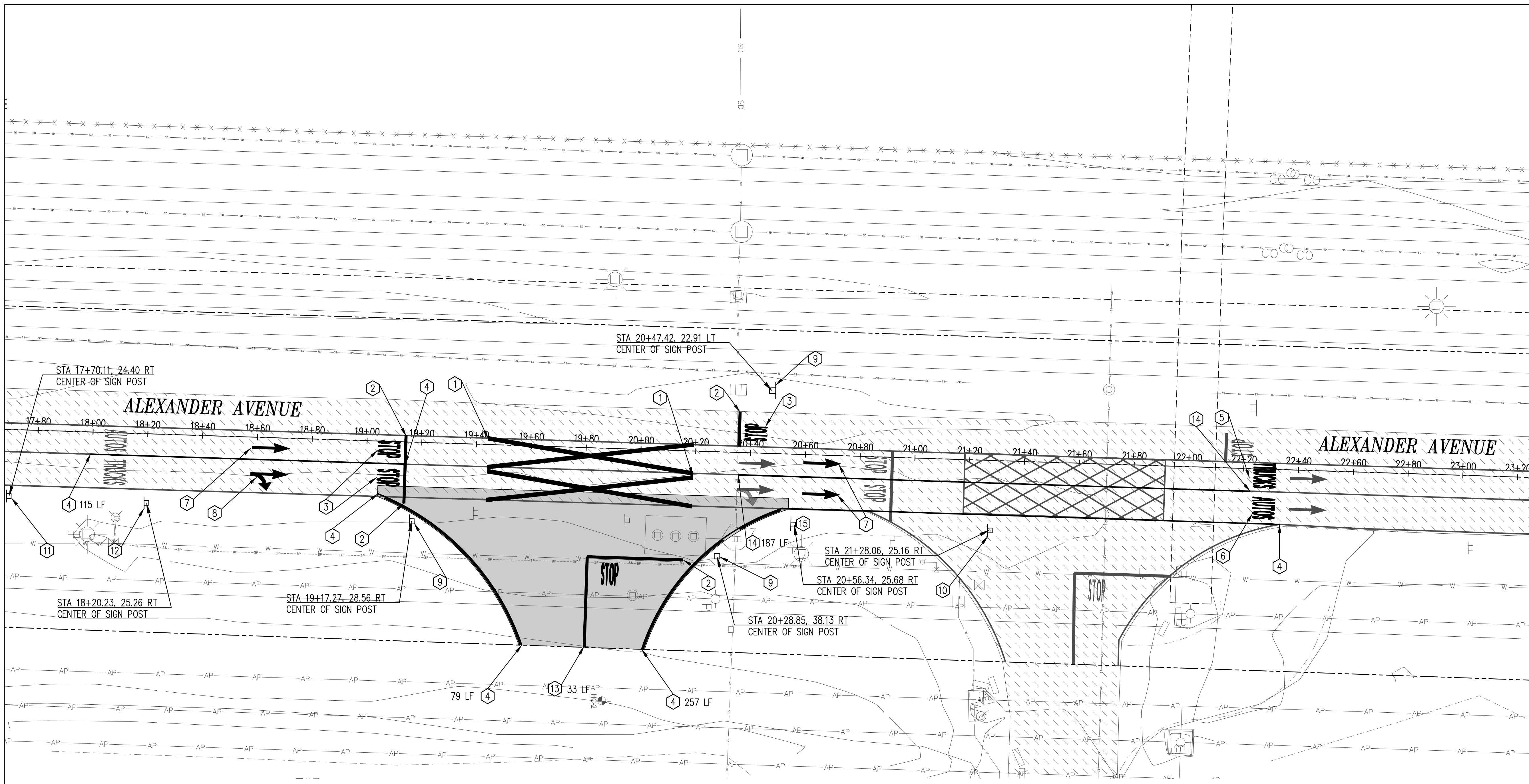

PLAN
SCALE: 1" = 20'

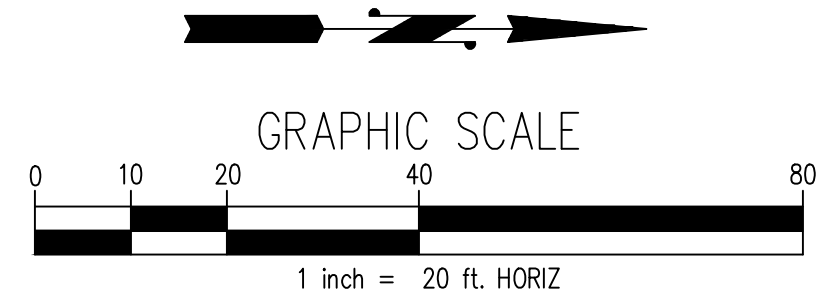

GENERAL NOTES:

1. ALL CHANNELIZATION AND SIGNAGE WORK IS NOT INCLUDED IN CONTRACT.

KEY NOTES:

- ① 12" SOLID WHITE 'X' PER EACH NORTHBOUND LANE
- ② 12" THERMOPLASTIC STOP BAR
- ③ 8' THERMOPLASTIC HIGH LETTER MARKING "STOP"
- ④ 4" WIDE THERMOPLASTIC SOLID WHITE STRIPING
- ⑤ 8' THERMOPLASTIC HIGH LETTER MARKING "TRUCKS"
- ⑥ 8' THERMOPLASTIC HIGH LETTER MARKING "AUTOS"
- ⑦ THERMOPLASTIC STRAIGHT ARROW
- ⑧ THERMOPLASTIC STRAIGHT AND RIGHT TURN ARROW COMBINATION
- ⑨ INSTALL SALVAGED STOP SIGN
- ⑩ INSTALL SALVAGED TRUCK/AUTO LANE DELINEATION SIGN
- ⑪ INSTALL SALVAGED STOP AHEAD WARNING SIGN PER MUTCD
- ⑫ INSTALL SALVAGED LANE CONTROL SIGN
- ⑬ 4" WIDE THERMOPLASTIC DOUBLE YELLOW STRIPING
- ⑭ 4" WIDE THERMOPLASTIC WHITE SKIP STRIPING
- ⑮ INSTALL R10-7 "DO NOT BLOCK INTERSECTION" SIGN PER MUTCD 3B.17

kpff
2407 North 31st Street, Suite 100
Tacoma, Washington 98407
(253) 396-0150 Fax (253) 396-0162

**CALL 48 HOURS
BEFORE YOU DIG
1-800-424-5555**



NO	REVISION	DATE	APPD

FINAL CONSTRUCTION CHECKED	DATE 06/18/20	SCALE AS SHOWN
DESIGNED CMB	CHECKED SWK	PROJECT NAME
DRAWN RRL	DRAWING NAME	
FIELD BOOKS		



SITE AND BUILDING DIVISION

CITY OF TACOMA
DEPARTMENT OF PUBLIC WORKS
ALEXANDER AVE DRIVEWAY IMPROVEMENTS
4215 SR 509
CHANNELIZATION AND SIGNAGE PLAN

WO19-0155
SHEET NO.
SHEET 8 OF 10

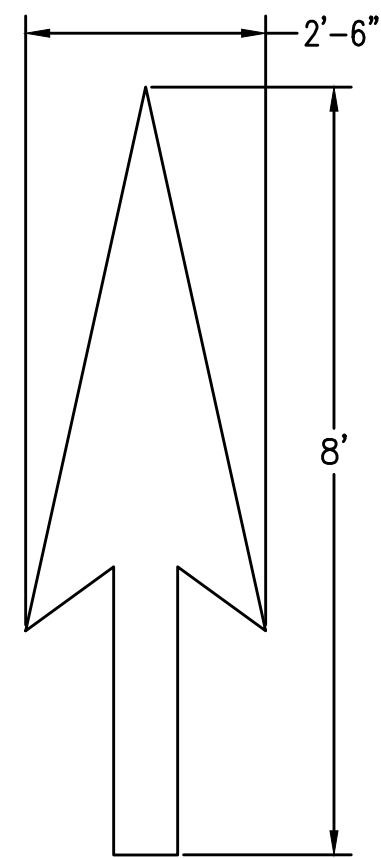

NOTE:
1. TRAFFIC ARROW PER CITY OF TACOMA STANDARD DETAIL CH-10 PAVEMENT WORDS AND ARROWS.

TRAFFIC ARROW DETAIL (NIC)

SCALE: NTS

1
8

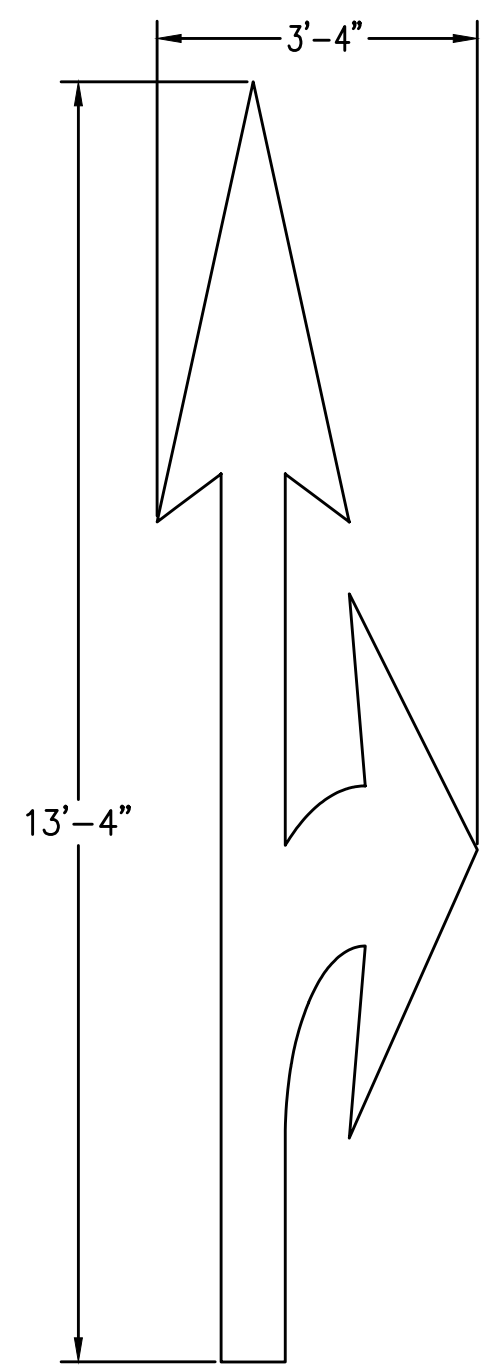

NOTE:
1. TRAFFIC ARROW PER CITY OF TACOMA STANDARD DETAIL CH-10 PAVEMENT WORDS AND ARROWS.
2. ARROWS MAY BE MIRRORED ABOUT THEIR CENTERLINE AS APPLICABLE TO DESIGN.

COMBINATION TRAFFIC ARROW DETAIL (NIC)

SCALE: NTS

2
8

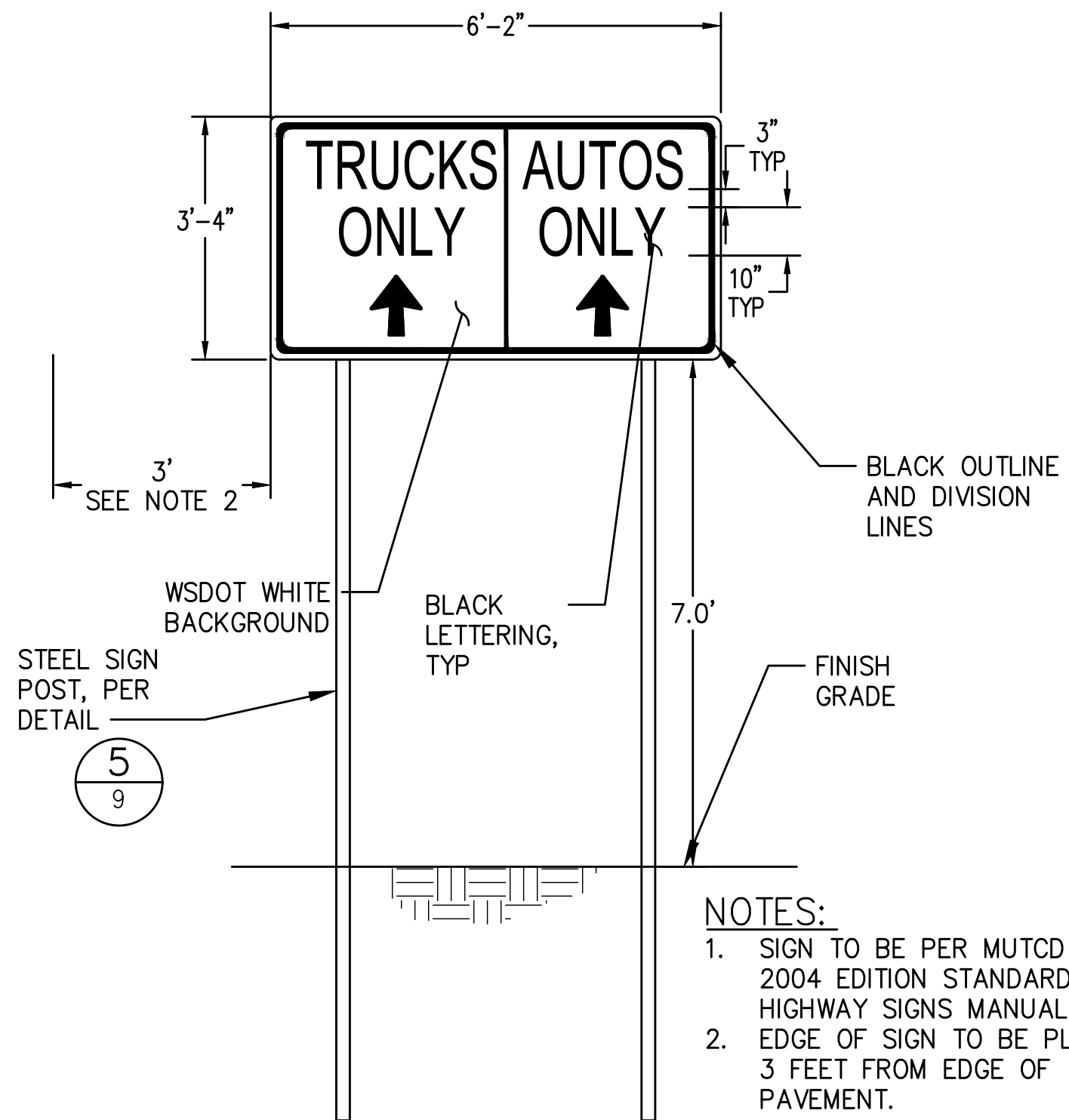

NOTES:
1. SIGN TO BE PER MUTCD AND 2004 EDITION STANDARD HIGHWAY SIGNS MANUAL.
2. EDGE OF SIGN TO BE PLACED 3 FEET FROM EDGE OF PAVEMENT.

AUTO/TRUCK DELINEATION SIGN DETAIL (NIC)

SCALE: NTS

3
8

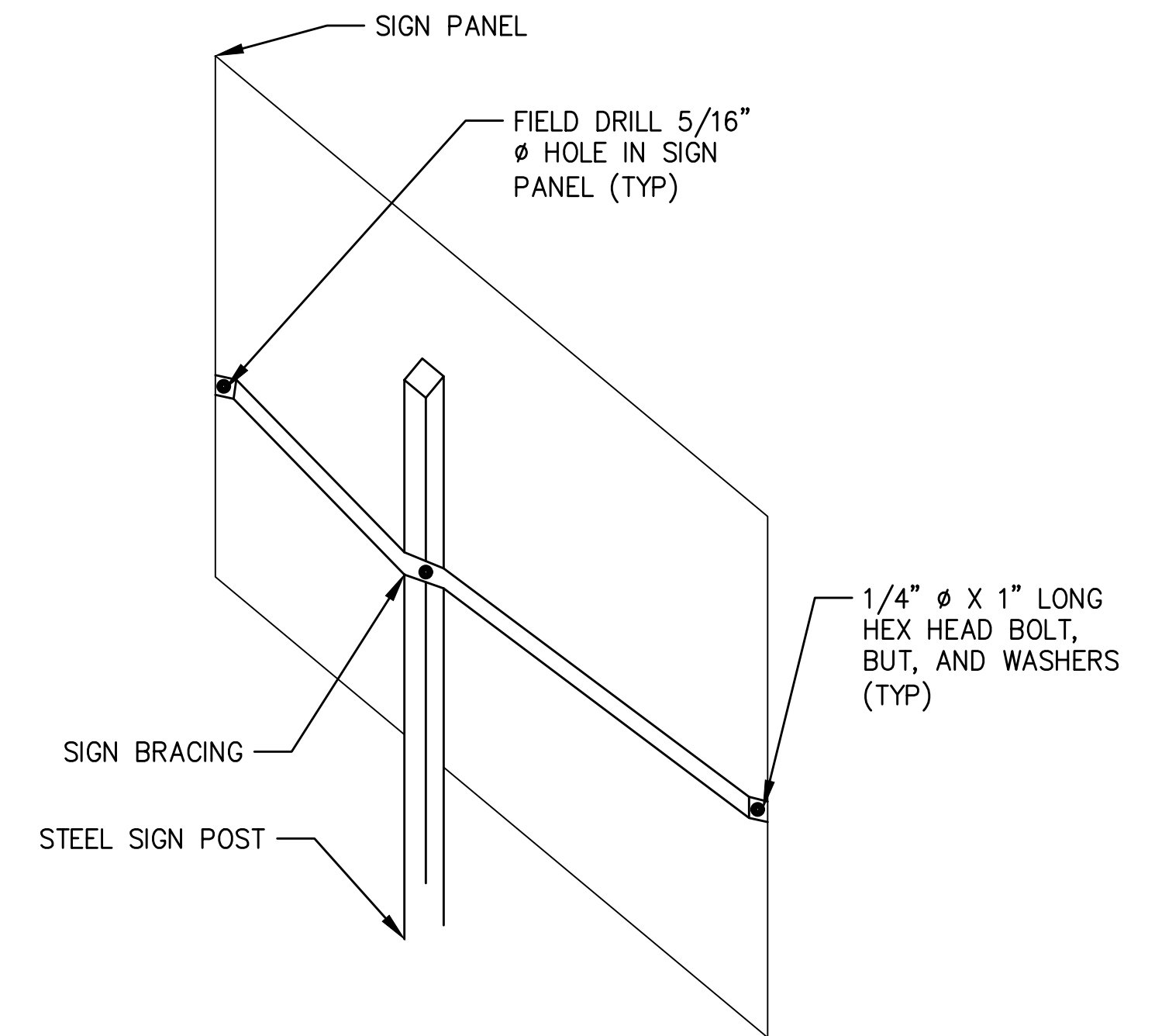

SIGN BRACING DETAIL (NIC)

SCALE: NTS

4
-

NOTES:

1. SURFACE MOUNTING OF SIGN POST, ESPECIALLY WITHIN TRAFFIC ISLANDS OR MEDIANS, IS ONLY ALLOWABLE WITH SPECIAL AUTHORIZATION FROM THE CITY'S TRAFFIC ENGINEERING GROUP, (EXCEPTION: SURFACE MOUNTING OF FLEXIBLE POST OBJECT MARKERS WITHIN ISLANDS OR MEDIANS IS PERMITTED).
2. IF FINISHED GROUND LINE IS A HARD SURFACE, THEN COMPACTED NATIVE BACKFILL MATERIAL SHALL BE CONCRETE WITH THE TOP FOUNDATION BEING SMOOTH, DENSE, AND UNIFORM TO FINISHED GROUND LINE.
3. SIGN POST PER CITY OF TACOMA STANDARD DETAIL SU-34 SIGN POST INSTALLATION.

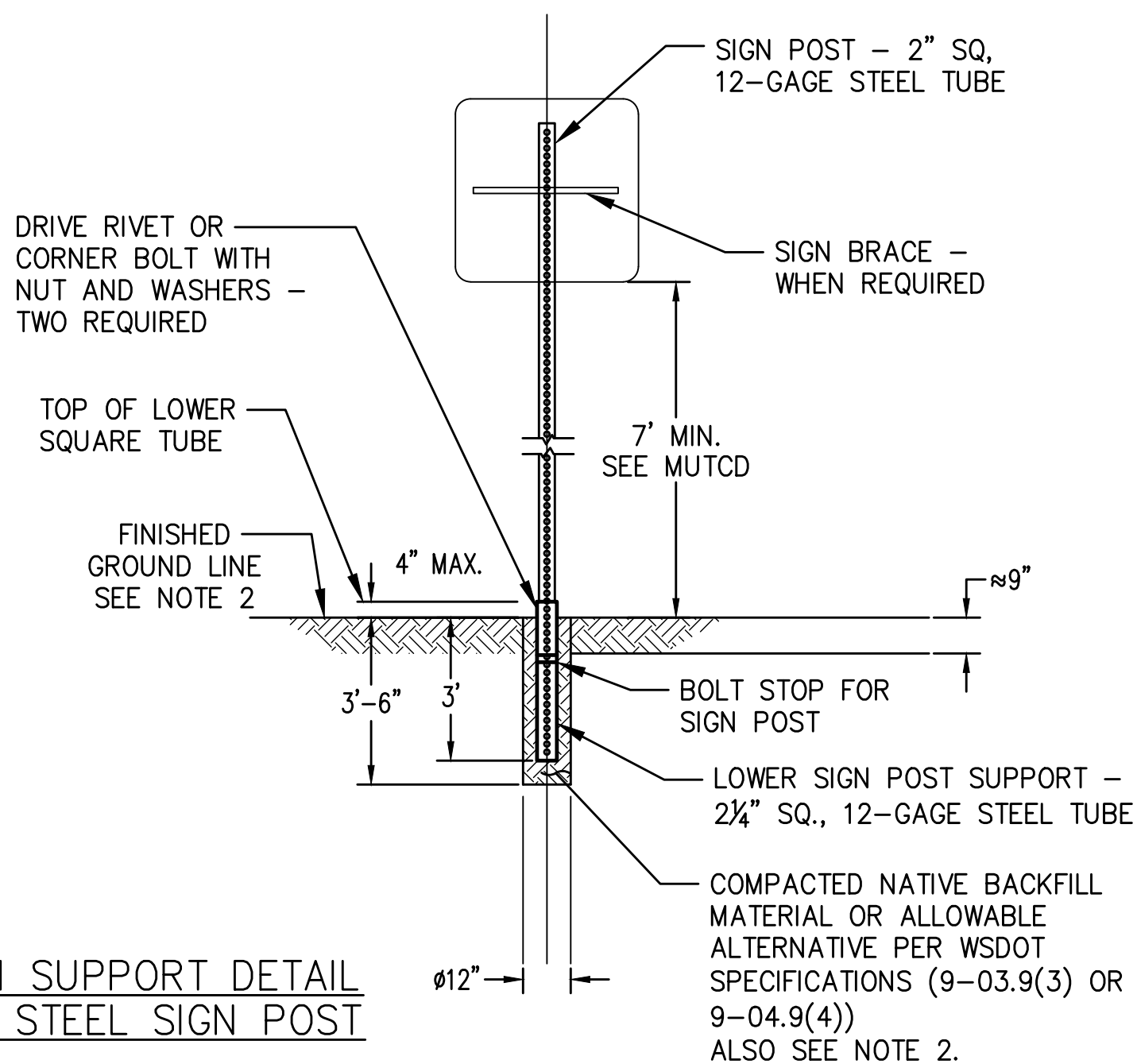

SIGN SUPPORT DETAIL FOR STEEL SIGN POST

SIGN POST DETAIL (NIC)

SCALE: NTS

5
8

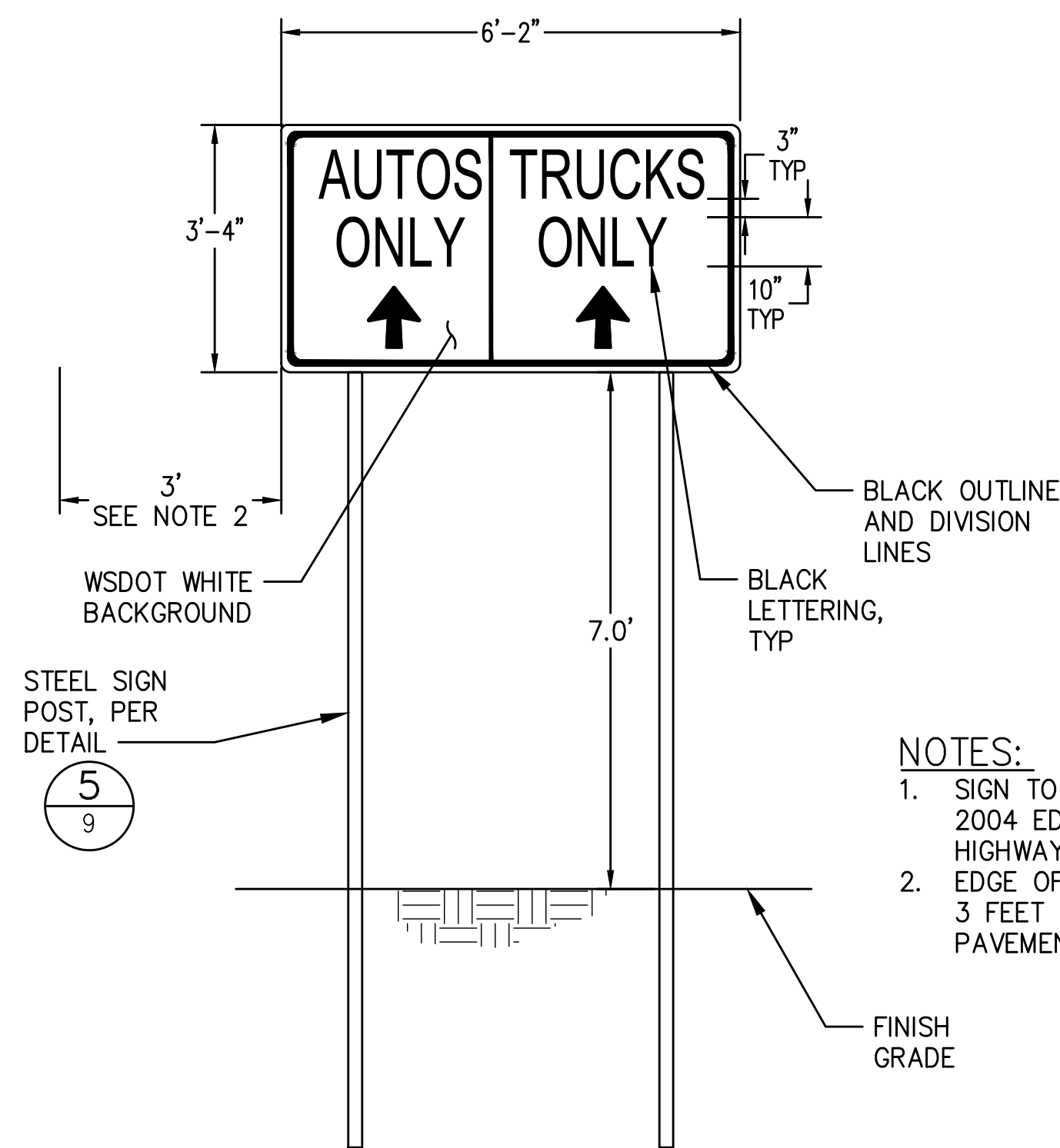

NOTES:
1. SIGN TO BE PER MUTCD AND 2004 EDITION STANDARD HIGHWAY SIGNS MANUAL.
2. EDGE OF SIGN TO BE PLACED 3 FEET FROM EDGE OF PAVEMENT.

LANE CONTROL SIGN DETAIL (NIC)

SCALE: NTS

6
8

